



# 2009 CAN VIM & PATS Programming Lookup Charts

# CAN VIM Vehicle Look-Up Chart

for use with NGS XLC and NGS XLC Locksmith only

2005 and newer model year vehicles only

## How to Use This Chart

Before you begin using NGS XLC to diagnose a 2005 or newer model year vehicle, you will need to select a VIM based on the vehicle and module you are testing. Use this chart to select the proper VIM.

### To select a VIM:

- Using the chart for the model year of the test vehicle, locate the column that lists the vehicle.
- Follow the column down to the row that lists the module you want to diagnose. This will show you which VIM to use:
  - VIM 1—use the Standard VIM
  - CAN—use the CAN VIM
  - For all non-CAN modules, use VIM 1

*Note: A dash (—) indicates the vehicle does not have that particular module.*

## Hookup Procedures

**⚠** Before you begin, make sure the vehicle's ignition key is in the OFF position, and that NGS XLC is not connected to power.

- Select the correct VIM (standard or CAN) according to the chart and insert the VIM into the Control Unit.

Make sure to insert the VIM to the level of the Barrier Line and that the Barrier Line fits snugly next to the Control Unit.

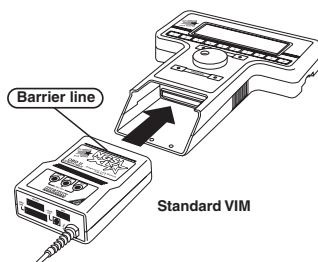

- If using the standard VIM:

- Connect the OBDII (or UBP cable depending upon application) adapter to NGS XLC at the **DIAG LINK** port.

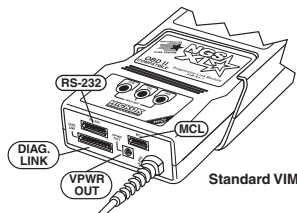

If using the CAN VIM:

- Connect the NGS CAN adapter cable to NGS XLC at the **CAN LINK** port.

- Select the correct program card from the chart below based on the VIM, function, and vehicle model year:

NGS Program Card Applications Chart				
Function	VIM 1 (non-CAN)		CAN VIM	
	Years	Color	Years	Color
<b>Diagnostic:</b> • Diagnostic test modes • PID data monitor & record • Active commands • Digital measurement system • Other diagnostic functions	1984–2001	Black	2003–and newer	Brown
	1999–2004	Red		
	2005–2007	Orange		
<b>Service:</b> • Module configure • PATS function • ABS service bleed • Programmable Module Installation • Generic OBDII functions (non-CAN) • Other service bay functions	1994–2007	Violet	2003–and newer	Gray

- With the front label facing the back of NGS XLC and the arrow pointing to the slot, insert the program card into the slot.

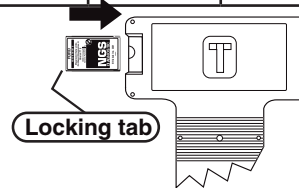

- Before inserting the card, make sure the locking tab located at the top of the card is in the locked position as indicated on the back of the card.
  - If the card is inserted incorrectly, NGS XLC will not work.
- Connect the other end of the OBDII connector to the vehicle at the OBDII port.
    - The port is located in the driver's compartment, on the dash panel, near the steering column.

## Connecting to Power Using the Standard VIM

The NGS XLC with the standard VIM installed is

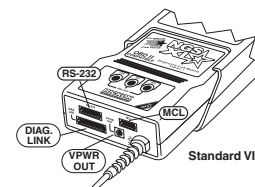

powered through the permanently attached lighter plug power cable. This cable can be left connected to the OBDII cable and the NGS will be powered from the vehicle's connector.

If there is no power at the vehicle's OBDII connector (check the vehicle's fuses), the NGS power cable can be connected to another source of battery voltage. *Note: The OBDII cable must still be connected to the vehicle.*

## Connecting to Power Using the CAN VIM

The NGS XLC with the CAN VIM installed is powered through the OBDII cable

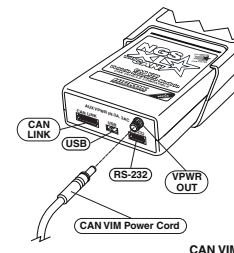

connected to the vehicle's OBDII connector.

If the vehicle's OBDII connector does not have power (check the vehicle's fuses), the CAN VIM power cable can be connected from the CAN VIM to a source of battery voltage. *The CAN VIM must still be connected to the vehicle's OBDII connector.*

# 2005 Vehicles

vehicle	Aviator	Crown Vic	Econoline	Econoline	Econoline	Econoline	Econoline	Econoline	Escape	Escape	Excursion	Excursion	Excursion	Expedition	Expedition	Explorer	Explorer
engine	4.6L	4.6 L	4.2 L	4.6 L	5.4 L	6.0 L	6.8 L	2.3 L	3.0 L	5.4 L	6.0L	6.8 L	4.6 L	5.4 L	4.0 L	4.6L	
modifier								Diesel					Diesel				

PCM	Powertrain Control Module	VIM 1	CAN	CAN	CAN	CAN	CAN	CAN	CAN	CAN	VIM 1	VIM 1	VIM 1	CAN	CAN	CAN	CAN
ABS	Anti - lock Brake Module	VIM 1	CAN	VIM 1	VIM 1	VIM 1	VIM 1	VIM 1	CAN	CAN	VIM 1	VIM 1	VIM 1	CAN	CAN	CAN	CAN
ACM	Audio Control Module	—	—	—	—	—	—	—	—	—	—	—	—	—	—	—	—
AFCM	Alternate Fuel Control Module	—	—	—	—	VIM 1	VIM 1	VIM 1	—	—	—	—	—	—	—	—	—
DATC	Dual Elec Auto Temp Ctrl Mod	VIM 1	—	—	—	—	—	—	—	—	—	—	—	—	—	—	—
DSCM	Driver Climate Seat Module	VIM 1	—	—	—	—	—	—	—	—	—	—	—	—	—	—	—
DDM	Driver Door Module	—	VIM 1	—	—	—	—	—	—	—	—	—	—	—	—	—	—
DSM	Driver Seat Module	VIM 1	—	—	—	—	—	—	—	—	VIM 1	VIM 1	VIM 1	CAN	CAN	VIM 1	VIM 1
EATC	Electronic Auto Temp Control	—	VIM 1	—	—	—	—	—	—	—	VIM 1	VIM 1	VIM 1	CAN	CAN	CAN	CAN
EPB	Electronic Parking Brake Module	—	—	—	—	—	—	—	—	—	—	—	—	—	—	—	—
FEM	Front Electronic Module	—	—	—	—	—	—	—	—	—	—	—	—	—	—	—	—
GEM	Generic Electronic Module	—	—	—	—	—	—	—	CAN	CAN	VIM 1	VIM 1	VIM 1	—	—	—	—
HEC	Hybrid Electronic Cluster	—	—	—	—	—	—	—	—	—	VIM 1	VIM 1	VIM 1	—	—	—	—
ICM	Instrument Cluster Mudule	VIM 1	—	CAN	CAN	CAN	CAN	CAN	CAN	CAN	—	—	—	CAN	CAN	CAN	CAN
LCM	Lighting Control Module	—	VIM 1	—	—	—	—	—	—	—	—	—	—	—	—	—	—
LTM	Liftgate / Trunk Module	—	—	—	—	—	—	—	—	—	—	—	—	—	—	—	—
MCM	Message Center Module	—	VIM 1	—	—	—	—	—	—	—	—	—	—	—	—	—	—
NAV	Navigation Module	VIM 1	—	—	—	—	—	—	—	—	—	—	—	—	—	—	—
NGSC	Next Generation Speed Control	—	—	—	—	—	—	—	—	—	—	—	—	—	—	—	—
OTC	Overhead Trip Computer	—	—	—	—	—	—	—	—	—	VIM 1	VIM 1	VIM 1	—	—	—	—
PAM	Parking Aid Module	VIM 1	—	—	—	—	—	—	VIM 1	VIM 1	VIM 1	VIM 1	VIM 1	VIM 1	VIM 1	VIM 1	VIM 1
PATS	Passive Anti - Theft Module	—	—	—	—	—	—	—	—	—	VIM 1	VIM 1	VIM 1	—	—	—	—
PCSM	Passenger Climate Seat Module	VIM 1	—	—	—	—	—	—	—	—	—	—	—	—	—	—	—
PSD1	Right Power Sliding Door Module	—	—	—	—	—	—	—	—	—	—	—	—	—	—	—	—
PSD2	Left Power Sliding Door Module	—	—	—	—	—	—	—	—	—	—	—	—	—	—	—	—
RAP	Remote Anti - Theft Module	—	—	VIM 1	VIM 1	VIM 1	VIM 1	VIM 1	—	—	—	—	—	—	—	—	—
RASM	Rear Air Suspension Module	—	VIM 1	—	—	—	—	—	—	—	—	—	—	—	—	—	—
RCM	Restraint Control Module	VIM 1	VIM 1	VIM 1	VIM 1	VIM 1	VIM 1	VIM 1	VIM 1	VIM 1	VIM 1	VIM 1	VIM 1	VIM 1	VIM 1	VIM 1	VIM 1
REM	Rear Electronics Module	—	—	—	—	—	—	—	—	—	—	—	—	—	—	—	—
RESC	Remote Emergency Satellite Unit	—	—	—	—	—	—	—	—	—	—	—	—	—	—	—	—
TCM	Transmission Control Module	—	—	—	—	—	—	—	—	—	—	VIM 1	—	—	—	—	—
TPM	Tire Pressure Monitor	VIM 1	—	—	—	—	—	—	—	—	—	—	—	—	—	—	—
VAPS	Variable Assist Power Steering	VIM 1	VIM 1	—	—	—	—	—	—	—	—	—	—	—	—	—	—
VDM	Vehicle Dynamics Module	—	—	—	—	—	—	—	—	—	—	—	—	—	—	—	—
VSM (CSM)	Vehicle Security Module	VIM 1	—	—	—	—	—	—	—	—	VIM 1	VIM 1	VIM 1	—	—	—	—
_4X4	4X4 Control Module	VIM 1	—	—	—	—	—	—	CAN	CAN	—	—	—	CAN	CAN	CAN	CAN



# 2005 Vehicles

vehicle	LS	Mariner	Monterey	Mountaineer	Mountaineer	Mustang	Mustang	Navigator	Ranger	Ranger	Ranger	Sable	Taurus	T'Bird	Town Car
engine	3.9 L	2.3/3.0L	4.2L	4.0 L	4.6 L	4.0 L	4.6 L	5.4 L	2.3L	3.0 L	4.0 L	3.0 L	3.0 L	3.9L	4.6 L
modifier	PTEC														

Select the Ford Escape when diagnosing this vehicle

PCM	Powertrain Control Module	CAN	VIM 1	CAN	CAN	CAN	CAN	CAN	CAN	VIM 1	VIM 1	VIM 1	CAN	CAN	CAN	CAN
ABS	Anti - lock Brake Module	VIM 1	VIM 1	CAN	CAN	CAN	CAN	CAN	CAN	VIM 1	VIM 1	VIM 1	CAN	CAN	VIM 1	CAN
ACM	Audio Control Module	VIM 1	—	—	—	CAN	CAN	—	—	—	—	—	—	—	VIM 1	VIM 1
AFCM	Alternate Fuel Control Module	—	—	—	—	—	—	—	—	—	—	—	—	—	—	—
DATC	Dual Elec Auto Temp Ctrl Mod	VIM 1	VIM 1	—	—	—	—	—	—	—	—	—	—	—	VIM 1	VIM 1
DSCSM	Driver Climate Seat Module	VIM 1	VIM 1	—	—	—	—	—	—	—	—	—	—	—	—	—
DDM	Driver Door Module	VIM 1	—	—	—	—	—	—	—	—	—	—	—	—	VIM 1	VIM 1
DSM	Driver Seat Module	VIM 1	VIM 1	VIM 1	—	—	CAN	—	—	—	—	—	—	—	—	VIM 1
EATC	Electronic Auto Temp Control	—	—	CAN	CAN	—	—	CAN	—	—	—	CAN	CAN	—	—	—
EPB	Electronic Parking Brake Module	VIM 1	—	—	—	—	—	—	—	—	—	—	—	—	—	—
FEM	Front Electronic Module	VIM 1	—	—	—	—	—	—	—	—	—	—	—	—	VIM 1	—
GEM	Generic Electronic Module	—	VIM 1	—	—	CAN	CAN	—	VIM 1	VIM 1	VIM 1	CAN	CAN	—	—	—
HEC	Hybrid Electronic Cluster	—	—	—	—	—	—	—	—	—	—	—	—	—	—	VIM 1
ICM	Instrument Cluster Mudule	VIM 1	VIM 1	CAN	CAN	CAN	CAN	CAN	CAN	CAN	CAN	CAN	CAN	CAN	VIM 1	—
LCM	Lighting Control Module	—	—	—	—	—	—	—	—	—	—	—	—	—	—	VIM 1
LTM	Liftgate / Trunk Module	—	VIM 1	—	—	—	—	—	—	—	—	—	—	—	—	VIM 1
MCM	Message Center Module	VIM 1	—	—	—	—	—	—	—	—	—	—	—	—	—	VIM 1
NAV	Navigation Module	VIM 1	—	—	—	—	—	VIM 1	—	—	—	—	—	—	—	VIM 1
NGSC	Next Generation Speed Control	—	VIM 1	—	—	—	—	—	—	—	—	—	—	—	—	—
OTC	Overhead Trip Computer	—	—	—	—	—	—	—	—	—	—	—	—	—	—	—
PAM	Parking Aid Module	VIM 1	VIM 1	VIM 1	—	—	VIM 1	—	—	—	—	—	—	—	—	VIM 1
PATS	Passive Anti - Theft Module	—	—	—	—	—	—	—	—	—	—	—	—	—	—	—
PCSM	Passenger Climate Seat Module	VIM 1	VIM 1	—	—	—	—	—	—	—	—	—	—	—	—	—
PSD1	Right Power Sliding Door Module	—	VIM 1	—	—	—	—	—	—	—	—	—	—	—	—	—
PSD2	Left Power Sliding Door Module	—	VIM 1	—	—	—	—	—	—	—	—	—	—	—	—	—
RAP	Remote Anti - Theft Module	—	—	—	—	—	—	—	—	—	—	—	—	—	—	—
RASM	Rear Air Suspension Module	—	—	—	—	—	—	—	—	—	—	—	—	—	—	VIM 1
RCM	Restraint Control Module	VIM 1	VIM 1	VIM 1	VIM 1	VIM 1	VIM 1	VIM 1	VIM 1	VIM 1	VIM 1	VIM 1	VIM 1	VIM 1	VIM 1	VIM 1
REM	Rear Electronics Module	VIM 1	—	—	—	—	—	—	—	—	—	—	—	—	VIM 1	—
RESC	Remote Emergency Satellite Unit	VIM 1	—	—	—	—	—	—	—	—	—	—	—	—	—	—
TCM	Transmission Control Module	—	—	—	—	—	—	—	—	—	—	—	—	—	—	—
TPM	Tire Pressure Monitor	—	—	—	—	—	—	—	—	—	—	—	—	—	—	—
VAPS	Variable Assist Power Steering	—	—	—	—	—	—	—	—	—	—	—	—	—	—	—
VDM	Vehicle Dynamics Module	—	—	—	—	—	—	—	—	—	—	—	—	—	—	—
VSM (CSM)	Vehicle Security Module	—	—	VIM 1	VIM 1	—	—	—	—	—	—	—	—	—	—	—
_4X4	4X4 Control Module	—	—	CAN	CAN	—	—	CAN	VIM 1	VIM 1	VIM 1	—	—	—	—	—

# 2006 Vehicles

vehicle	Crown Vic	Econoline	Econoline	Econoline	Econoline	Escape	Escape	Escape	Expedition	Explorer	Explorer	F - 150	F - 150
engine	4.6 L	4.6 L	5.4 L	6.0 L	6.8 L	2.3 L	3.0 L	2.3 L	5.4 L	4.0 L	4.6 L	4.2 L	4.6 L
modifier				Diesel				hybrid					

PCM	Powertrain Control Module	CAN	CAN	CAN	CAN	CAN	CAN	CAN	CAN	CAN	CAN	CAN	CAN
ABS	Anti - lock Brake Module	CAN	VIM 1	VIM 1	VIM 1	VIM 1	CAN	CAN	CAN	CAN	CAN	CAN	CAN
ACM	Audio Control Module	—	—	—	—	—	—	—	—	—	CAN	CAN	—
DATC	Dual Elec Auto Temp Ctrl Mod	—	—	—	—	—	—	—	—	—	—	—	—
DSCM	Driver Climate Seat Module	—	—	—	—	—	—	—	—	—	—	—	—
DDM	Driver Door Module	VIM 1	—	—	—	—	—	—	—	—	—	—	—
DSM	Driver Seat Module	—	—	—	—	—	—	—	—	CAN	—	CAN	VIM 1
EATC	Electronic Auto Temp Control	VIM 1	—	—	—	—	—	—	—	CAN	—	CAN	VIM 1
EPB	Electronic Parking Brake Module	—	—	—	—	—	—	—	—	—	—	—	—
FEM	Front Electronic Module	—	—	—	—	—	—	—	—	—	—	—	—
GEM (SJB)	Generic Electronic Module	—	—	—	—	—	CAN	CAN	CAN	—	CAN	CAN	—
HEC	Hybrid Electronic Cluster	—	—	—	—	—	—	—	—	—	—	—	—
ICM	Instrument Cluster Mudule	VIM 1	CAN	CAN	CAN	CAN	CAN	CAN	CAN	CAN	CAN	CAN	CAN
LCM	Lighting Control Module	VIM 1	—	—	—	—	—	—	—	—	—	—	—
LTM	Liftgate / Trunk Module	—	—	—	—	—	—	—	—	—	—	—	—
MCM	Message Center Module	VIM 1	—	—	—	—	—	—	—	—	—	—	—
NAV	Navigation Module	—	—	—	—	—	—	—	—	—	—	—	—
NGSC	Next Generation Speed Control	—	—	—	—	—	—	—	—	—	—	—	—
PAM	Parking Aid Module	—	—	—	—	—	VIM 1	VIM 1	—	VIM 1	—	—	VIM 1
PATS	Passive Anti - Theft Module	—	—	—	—	—	—	—	—	—	—	—	—
PCSM	Passenger Climate Seat Module	—	—	—	—	—	—	—	—	—	—	—	—
PSD1	Right Power Sliding Door Module	—	—	—	—	—	—	—	—	—	—	—	—
PSD2	Left Power Sliding Door Module	—	—	—	—	—	—	—	—	—	—	—	—
RAP	Remote Anti - Theft Module	—	VIM 1	VIM 1	VIM 1	VIM 1	—	—	—	—	—	—	—
RASM	Rear Air Suspension Module	VIM 1	—	—	—	—	—	—	—	—	—	—	—
RCM	Restraint Control Module	VIM 1	VIM 1	VIM 1	VIM 1	VIM 1	VIM 1	VIM 1	VIM 1	VIM 1	CAN	CAN	VIM 1
REM	Rear Electronics Module	—	—	—	—	—	—	—	—	—	—	—	—
TCM	Transmission / Transaxle Control Module	—	—	—	—	—	—	—	CAN	—	—	CAN	—
VAPS	Variable Assist Power Steering	VIM 1	—	—	—	—	—	—	—	—	—	—	—
VSM / BSM	Vehicle / Body Security Module	—	—	—	—	—	—	—	—	—	—	—	VIM 1
_4X4	4X4 Control Module	—	—	—	—	—	CAN	CAN	CAN	CAN	—	CAN	CAN

# 2006 Vehicles

vehicle	F - 150	F650/750	F650/750	F 800	500	Focus	Focus	Ford GT	Freestar	Freestar	Freestyle	F-S, S-D	F-S, S-D
engine	5.4 L	6.0 L	7.2L	5.9 L	3.0 L	2.0 L	2.3 L	5.4 L	3.9L	4.2L	3.0L	5.4 L	6.0L
modifier		Diesel	Diesel	Cummins									Diesel

PCM	Powertrain Control Module	CAN	—	—	—	CAN	CAN	CAN	VIM 1	CAN	CAN	CAN	CAN	CAN
ABS	Anti - lock Brake Module	CAN	CAN	CAN	CAN	CAN	CAN	CAN	VIM 1	CAN	CAN	CAN	CAN	CAN
ACM	Audio Control Module	—	—	—	—	CAN	—	—	—	—	—	CAN	—	—
DATC	Dual Elec Auto Temp Ctrl Mod	—	—	—	—	—	—	—	—	VIM 1	VIM 1	—	—	—
DSCM	Driver Climate Seat Module	—	—	—	—	—	—	—	—	VIM 1	VIM 1	—	—	—
DDM	Driver Door Module	—	—	—	—	—	—	—	—	—	—	—	—	—
DSM	Driver Seat Module	VIM 1	—	—	—	CAN	—	—	—	VIM 1	VIM 1	CAN	—	—
EATC	Electronic Auto Temp Control	VIM 1	—	—	—	CAN	—	—	—	VIM 1	VIM 1	CAN	VIM 1	VIM 1
EPB	Electronic Parking Brake Module	—	—	—	—	—	—	—	—	—	—	—	—	—
FEM	Front Electronic Module	—	—	—	—	—	—	—	—	—	—	—	—	—
GEM (SJB)	Generic Electronic Module	—	VIM 1	VIM 1	VIM 1	CAN	VIM 1	VIM 1	CAN	VIM 1	VIM 1	CAN	VIM 1	VIM 1
HEC	Hybrid Electronic Cluster	—	—	—	—	—	CAN	CAN	—	—	—	—	—	—
ICM	Instrument Cluster Mudule	CAN	—	—	—	CAN	—	—	VIM 1	VIM 1	VIM 1	CAN	CAN	CAN
LCM	Lighting Control Module	—	—	—	—	—	—	—	—	—	—	—	—	—
LTM	Liftgate / Trunk Module	—	—	—	—	—	—	—	—	VIM 1	VIM 1	—	—	—
MCM	Message Center Module	—	—	—	—	—	—	—	—	—	—	—	—	—
NAV	Navigation Module	—	—	—	—	—	—	—	—	—	—	—	—	—
NGSC	Next Generation Speed Control	—	—	—	—	—	—	—	—	VIM 1	VIM 1	—	—	—
PAM	Parking Aid Module	VIM 1	—	—	—	VIM 1	—	—	—	VIM 1	VIM 1	VIM 1	VIM 1	VIM 1
PATS	Passive Anti - Theft Module	—	—	—	—	—	—	—	VIM 1	—	—	—	—	—
PCSM	Passenger Climate Seat Module	—	—	—	—	—	—	—	—	VIM 1	VIM 1	—	—	—
PSD1	Right Power Sliding Door Module	—	—	—	—	—	—	—	—	VIM 1	VIM 1	—	—	—
PSD2	Left Power Sliding Door Module	—	—	—	—	—	—	—	—	VIM 1	VIM 1	—	—	—
RAP	Remote Anti - Theft Module	—	—	—	—	—	—	—	—	—	—	—	—	—
RASM	Rear Air Suspension Module	—	—	—	—	—	—	—	—	—	—	—	—	—
RCM	Restraint Control Module	VIM 1	—	—	—	CAN	CAN	CAN	VIM 1	VIM 1	VIM 1	CAN	VIM 1	VIM 1
REM	Rear Electronics Module	—	—	—	—	—	—	—	—	—	—	—	—	—
TCM	Transmission / Transaxle Control Module	—	—	—	—	—	—	—	—	—	—	—	—	—
VAPS	Variable Assist Power Steering	—	—	—	—	—	—	—	—	—	—	—	—	—
VSM / BSM	Vehicle / Body Security Module	VIM 1	—	—	—	—	—	—	—	—	—	—	VIM 1	VIM 1
_4X4	4X4 Control Module	CAN	—	—	—	CAN	—	—	—	—	—	CAN	—	—

# 2006 Vehicles

vehicle	F-S, S-D	Fusion	Fusion	Grand Mar	LS	Mariner	Mariner	Mariner	Mark LT	Milan	Milan	Montego	Monterey
engine	6.8 L	2.3 L	3.0 L	4.6 L	3.9 L	2.3L	3.0L	2.3 L	5.4 L	2.3 L	3.0 L	3.0 L	4.2 L
modifier								Hybrid	Lincoln				

PCM	Powertrain Control Module	CAN	CAN	CAN	CAN	VIM 1	Select the Ford Escape when diagnosing this vehicle	Select the Ford Escape when diagnosing this vehicle	Select the Ford Escape when diagnosing this vehicle	CAN	CAN	CAN	CAN	CAN		
ABS	Anti - lock Brake Module	CAN	CAN	CAN	CAN	VIM 1				CAN	CAN	CAN	CAN	CAN	CAN	CAN
ACM	Audio Control Module	—	CAN	CAN	—	VIM 1				—	CAN	CAN	CAN	CAN	—	—
DATC	Dual Elec Auto Temp Ctrl Mod	—	—	—	—	VIM 1				—	—	—	—	—	—	VIM 1
DCSM	Driver Climate Seat Module	—	—	—	—	VIM 1				—	—	—	—	—	—	VIM 1
DDM	Driver Door Module	—	—	—	VIM 1	VIM 1				—	—	—	—	—	—	—
DSM	Driver Seat Module	—	—	—	—	VIM 1				VIM 1	—	—	—	CAN	CAN	VIM 1
EATC	Electronic Auto Temp Control	VIM 1	CAN	CAN	VIM 1	—				VIM 1	CAN	CAN	CAN	CAN	CAN	VIM 1
EPB	Electronic Parking Brake Module	—	—	—	—	VIM 1				—	—	—	—	—	—	—
FEM	Front Electronic Module	—	—	—	—	VIM 1				—	—	—	—	—	—	—
GEM (SJB)	Generic Electronic Module	VIM 1	CAN	CAN	—	—				—	CAN	CAN	CAN	CAN	CAN	VIM 1
HEC	Hybrid Electronic Cluster	—	—	—	—	—				—	—	—	—	—	—	—
ICM	Instrument Cluster Mudule	CAN	CAN	CAN	VIM 1	VIM 1				CAN	CAN	CAN	CAN	CAN	CAN	VIM 1
LCM	Lighting Control Module	—	—	—	VIM 1	—				—	—	—	—	—	—	—
LTM	Liftgate / Trunk Module	—	—	—	—	—				—	—	—	—	—	—	VIM 1
MCM	Message Center Module	—	—	—	VIM 1	—				—	—	—	—	—	—	—
NAV	Navigation Module	—	—	—	—	VIM 1				—	—	—	—	—	—	—
NGSC	Next Generation Speed Control	—	—	—	—	—				—	—	—	—	—	—	VIM 1
PAM	Parking Aid Module	VIM 1	—	—	—	VIM 1				VIM 1	—	—	—	VIM 1	VIM 1	VIM 1
PATS	Passive Anti - Theft Module	—	—	—	—	—				—	—	—	—	—	—	—
PCSM	Passenger Climate Seat Module	—	—	—	—	VIM 1				—	—	—	—	—	—	VIM 1
PSD1	Right Power Sliding Door Module	—	—	—	—	—				—	—	—	—	—	—	VIM 1
PSD2	Left Power Sliding Door Module	—	—	—	—	—				—	—	—	—	—	—	VIM 1
RAP	Remote Anti - Theft Module	—	—	—	—	—				—	—	—	—	—	—	—
RASM	Rear Air Suspension Module	—	—	—	VIM 1	—				—	—	—	—	—	—	—
RCM	Restraint Control Module	VIM 1	CAN	CAN	VIM 1	VIM 1	VIM 1	CAN	CAN	CAN	CAN	CAN	VIM 1			
REM	Rear Electronics Module	—	—	—	—	VIM 1	—	—	—	—	—	—	—			
TCM	Transmission / Transaxle Control Module	—	CAN	CAN	—	—	—	CAN	CAN	—	—	—	—			
VAPS	Variable Assist Power Steering	—	—	—	VIM 1	—	—	—	—	—	—	—	—			
VSM / BSM	Vehicle / Body Security Module	VIM 1	—	—	—	—	VIM 1	—	—	—	—	—	—			
_4X4	4X4 Control Module	—	—	—	—	—	—	CAN	—	—	—	CAN	—			



# 2006 Vehicles

		vehicle	Mountaineer	Mountaineer	Mustang	Mustang	Navigator	Ranger	Ranger	Ranger	Taurus	Town Car	Zephyr
		engine	4.0 L	4.6 L	4.0 L	4.6 L	5.4 L	2.3L	3.0 L	4.0 L	3.0 L	4.6 L	3.0 L
		modifier											
PCM	Powertrain Control Module	CAN	CAN	CAN	CAN	CAN	CAN	VIM 1	VIM 1	VIM 1	CAN	CAN	CAN
ABS	Anti - lock Brake Module	CAN	CAN	CAN	CAN	CAN	CAN	VIM 1	VIM 1	VIM 1	CAN	CAN	CAN
ACM	Audio Control Module	CAN	CAN	CAN	CAN	—	—	—	—	—	—	VIM 1	CAN
DATC	Dual Elec Auto Temp Ctrl Mod	—	—	—	—	—	—	—	—	—	—	VIM 1	—
DSCSM	Driver Climate Seat Module	—	—	—	—	—	—	—	—	—	—	—	—
DDM	Driver Door Module	—	—	—	—	—	—	—	—	—	—	VIM 1	—
DSM	Driver Seat Module	—	CAN	—	—	CAN	—	—	—	—	—	VIM 1	CAN
EATC	Electronic Auto Temp Control	—	CAN	—	—	CAN	—	—	—	—	CAN	—	CAN
EPB	Electronic Parking Brake Module	—	—	—	—	—	—	—	—	—	—	—	—
FEM	Front Electronic Module	—	—	—	—	—	—	—	—	—	—	—	—
GEM (SJB)	Generic Electronic Module	CAN	CAN	CAN	CAN	—	VIM 1	VIM 1	VIM 1	VIM 1	CAN	—	CAN
HEC	Hybrid Electronic Cluster	—	—	—	—	—	—	—	—	—	—	VIM 1	—
ICM	Instrument Cluster Mudule	CAN	CAN	CAN	CAN	CAN	CAN	CAN	CAN	CAN	CAN	—	CAN
LCM	Lighting Control Module	—	—	—	—	—	—	—	—	—	—	VIM 1	—
LTM	Liftgate / Trunk Module	—	—	—	—	—	CAN	—	—	—	—	VIM 1	—
MCM	Message Center Module	—	—	—	—	—	—	—	—	—	—	—	—
NAV	Navigation Module	—	—	—	—	—	VIM 1	—	—	—	—	VIM 1	—
NGSC	Next Generation Speed Control	—	—	—	—	—	—	—	—	—	—	—	—
PAM	Parking Aid Module	—	—	—	—	—	VIM 1	—	—	—	—	VIM 1	—
PATS	Passive Anti - Theft Module	—	—	—	—	—	—	—	—	—	—	—	—
PCSM	Passenger Climate Seat Module	—	—	—	—	—	—	—	—	—	—	—	—
PSD1	Right Power Sliding Door Module	—	—	—	—	—	—	—	—	—	—	—	—
PSD2	Left Power Sliding Door Module	—	—	—	—	—	—	—	—	—	—	—	—
RAP	Remote Anti - Theft Module	—	—	—	—	—	—	—	—	—	—	—	—
RASM	Rear Air Suspension Module	—	—	—	—	—	—	—	—	—	—	VIM 1	—
RCM	Restraint Control Module	CAN	CAN	VIM 1	VIM 1	VIM 1	VIM 1	VIM 1	VIM 1	VIM 1	VIM 1	VIM 1	CAN
REM	Rear Electronics Module	—	—	—	—	—	—	—	—	—	—	—	—
TCM	Transmission / Transaxle Control Module	—	CAN	—	—	—	CAN	—	—	—	—	—	CAN
VAPS	Variable Assist Power Steering	—	—	—	—	—	—	—	—	—	—	—	—
VSM / BSM	Vehicle / Body Security Module	—	—	—	—	—	—	—	—	—	—	—	—
_4X4	4X4 Control Module	—	CAN	—	—	—	CAN	VIM 1	VIM 1	VIM 1	—	—	—



# 2007 Vehicles

vehicle	Crown Vic	Econoline	Econoline	Econoline	Econoline	Edge	Escape	Escape	Escape	Expedition	Explorer
engine	4.6 L	4.6 L	5.4 L	6.0 L	6.8 L	3.5 L	2.3 L	3.0 L	2.3 L	5.4 L	4.0 L
modifier				Diesel					hybrid		

LTM	Liftgate / Trunk Module	—	—	—	—	—	CAN	—	—	—	CAN	—
MCM	Message Center Module	VIM1	—	—	—	—	—	—	—	—	—	—
NAV	Navigation Module	—	—	—	—	—	—	—	—	—	—	—
NGSC	Next Generation Speed Control	—	—	—	—	—	—	—	—	—	—	—
OCS / SWS	Occupant Classification Sensor Module	—	—	—	—	—	CAN	—	—	—	—	CAN
PAM	Parking Aid Module	—	VIM1	—	—	—	CAN	VIM1	VIM1	VIM1	CAN	—
PATS	Passive Anti - Theft Module	—	—	—	—	—	—	—	—	—	—	—
PCSM	Passenger Climate Seat Module	—	—	—	—	—	CAN	—	—	—	—	—
PRB	Power Running Board	—	—	—	—	—	—	—	—	—	CAN	—
PSCM	Power Steering Control Module	—	—	—	—	—	—	—	—	CAN	—	—
PSD1	Right Power Sliding Door Module	—	—	—	—	—	—	—	—	—	—	—
PSD2	Left Power Sliding Door Module	—	—	—	—	—	—	—	—	—	—	—
RAP	Remote Anti - Theft Module	—	—	—	—	—	—	—	—	—	—	—
RASM	Rear Air Suspension Module	CAN	—	—	—	—	—	—	—	—	—	—
RATC	Rear Air Temp Dontrol	—	—	—	—	—	—	—	—	—	—	—
RCM	Restraint Control Module	VIM1	VIM1	VIM1	VIM1	VIM1	CAN	VIM1	VIM1	VIM1	CAN	CAN
REM	Rear Electronics Module	—	—	—	—	—	—	—	—	—	—	—
RESC	Remote Emergency Satellite Unit	—	—	—	—	—	—	—	—	—	—	—
RETM / RSE	Rear Entertainment Module	—	—	—	—	—	CAN	—	—	—	CAN	—
SASM	Steering Angle Sensor Module	—	—	—	—	—	CAN	—	—	—	—	—
SDAR	Satellite Digital Audio Receiver	—	—	—	—	—	CAN	—	—	—	CAN	—
TBC	Trailer Brake Control Module	—	—	—	—	—	—	—	—	—	—	—
TCM	Transmission / Transaxle Control Module	—	—	—	—	—	—	—	—	CAN	CAN	—
VAPS	Variable Assist Power Steering	—	—	—	—	—	—	—	—	—	—	—
VDM	Vehicle Dynamics Module	—	—	—	—	—	—	—	—	—	CAN	—
VSM / BSM	Vehicle / Body Security Module	—	CAN	CAN	CAN	CAN	—	—	—	—	—	—
_4X4	4X4 Control Module	—	—	—	—	—	CAN	—	—	—	CAN	—



# 2007 Vehicles

vehicle	Explorer	F - 150	F - 150	F - 150	F650/750	F650/750	F-800	500	Focus	Focus	Freestar
engine	4.6 L	4.2 L	4.6 L	5.4 L	6.0 L	7.2L	5.9 L	3.0 L	2.0 L	2.3 L	3.9L
modifier					Diesel	Cat	Cummins				

LTM	Liftgate / Trunk Module	—	—	—	—	—	—	—	—	—	—	VIM1
MCM	Message Center Module	—	—	—	—	—	—	—	—	—	—	—
NAV	Navigation Module	—	—	—	—	—	—	—	—	—	—	—
NGSC	Next Generation Speed Control	—	—	—	—	—	—	—	—	—	—	VIM1
OCS / SWS	Occupant Classification Sensor Module	CAN	—	—	—	—	—	—	CAN	CAN	—	—
PAM	Parking Aid Module	CAN	VIM1	VIM1	VIM1	—	—	—	VIM1	—	—	VIM1
PATS	Passive Anti - Theft Module	—	—	—	—	—	—	—	—	—	—	—
PCSM	Passenger Climate Seat Module	—	—	—	—	—	—	—	—	—	—	VIM1
PRB	Power Running Board	—	—	—	—	—	—	—	—	—	—	—
PSCM	Power Steering Control Module	—	—	—	—	—	—	—	—	—	—	—
PSD1	Right Power Sliding Door Module	—	—	—	—	—	—	—	—	—	—	VIM1
PSD2	Left Power Sliding Door Module	—	—	—	—	—	—	—	—	—	—	VIM1
RAP	Remote Anti - Theft Module	—	—	—	—	—	—	—	—	—	—	—
RASM	Rear Air Suspension Module	—	—	—	—	—	—	—	—	—	—	—
RATC	Rear Air Temp Dontrol	—	—	—	—	—	—	—	—	—	—	—
RCM	Restraint Control Module	CAN	VIM1	VIM1	VIM1	—	—	—	CAN	CAN	CAN	VIM1
REM	Rear Electronics Module	—	—	—	—	—	—	—	—	—	—	—
RESC	Remote Emergency Satellite Unit	—	—	—	—	—	—	—	—	—	—	—
RETM / RSE	Rear Entertainment Module	CAN	CAN	CAN	CAN	—	—	—	CAN	—	—	—
SASM	Steering Angle Sensor Module	—	—	—	—	—	—	—	—	—	—	—
SDAR	Satellite Digital Audio Receiver	CAN	CAN	CAN	CAN	—	—	—	CAN	—	—	—
TBC	Trailer Brake Control Module	—	—	—	—	—	—	—	—	—	—	—
TCM	Transmission / Transaxle Control Module	CAN	—	—	—	—	—	—	CAN	—	—	—
VAPS	Variable Assist Power Steering	—	—	—	—	—	—	—	—	—	—	—
VDM	Vehicle Dynamics Module	—	—	—	—	—	—	—	—	—	—	—
VSM / BSM	Vehicle / Body Security Module	—	VIM1	VIM1	VIM1	—	—	—	—	—	—	—
_4X4	4X4 Control Module	CAN	CAN	CAN	CAN	—	—	—	CAN	—	—	—

# 2007 Vehicles

vehicle	Freestar	Freestyle	Fusion	Fusion	F-S, S-D	F-S, S-D	F-S, S-D	Grand Mar	Mariner	Mariner	Mariner
engine	4.2L	3.0L	2.3 L	3.0 L	5.4 L	6.0L	6.8 L	4.6 L	2.3L	3.0L	2.3 L
modifier							Diesel				Hybrid

PCM	Powertrain Control Module	CAN	CAN	CAN	CAN	CAN	CAN	CAN	CAN	CAN	CAN	CAN
ABS	Anti - lock Brake Module	CAN	CAN	CAN	CAN	CAN	CAN	CAN	CAN	CAN	CAN	—
ABS / RSC	ABS / Roll Stability Control	—	—	—	—	—	—	—	—	—	—	—
ACM	Audio Control Module	—	CAN	CAN	CAN	—	—	—	—	—	—	—
ACMN	ACM / Navigation	—	CAN	—	—	—	—	—	—	—	—	—
ACP	Audio Control Protocol Gateway Module	—	—	—	—	—	—	—	—	—	—	CAN
ASM	Air Suspension Module (4 wheel)	—	—	—	—	—	—	—	—	—	—	—
BCM TBCM	Battery Control Module	—	—	—	—	—	—	—	—	—	—	CAN
BSCM	Brake System Control Module	—	—	—	—	—	—	—	—	—	—	CAN
CCSM	Climate Control Seat Module	—	—	—	—	—	—	—	—	—	—	—
CVT	Continuously Variable Transmission	—	CAN	—	—	—	—	—	—	—	—	—
DATC	Dual Elec Auto Temp Ctrl Mod	—	—	—	—	—	—	—	—	—	—	—
DCSM	Driver Climate Seat Module	VIM1	—	—	—	—	—	—	—	—	—	—
DDM	Driver Door Module	—	—	—	—	—	—	—	VIM1	—	—	—
DEM	Differential Control Module	—	—	—	—	—	—	—	—	—	—	—
DSM	Driver Seat Module	VIM1	CAN	—	—	—	—	—	—	—	—	—
DSP	Digital Signal Processing Module	—	—	—	—	—	—	—	—	—	—	—
EATC	Electronic Auto Temp Control	VIM1	CAN	CAN	CAN	VIM1	VIM1	VIM1	VIM1	—	—	—
EMTC	Electronic Manual Temp Control	VIM1	—	—	—	—	—	—	—	—	—	—
EPB	Electronic Parking Brake Module	—	—	—	—	—	—	—	—	—	—	—
FEM	Front Electronic Module	—	—	—	—	—	—	—	—	—	—	—
FSSM	Fire Supression Module	—	—	—	—	—	—	—	CAN	—	—	—
GEM (SJB)	Generic Electronic Module	VIM1	CAN	CAN	CAN	—	—	—	—	CAN	CAN	CAN
HEC	Hybrid Electronic Cluster	—	—	—	—	—	—	—	—	—	—	—
ICM	Instrument Cluster Mudule	CAN	CAN	CAN	CAN	CAN	CAN	CAN	CAN	CAN	CAN	CAN
ITCCM	Intelligent Torque Control Coupling Module	—	—	—	—	—	—	—	—	CAN	CAN	CAN
LCM	Lighting Control Module	—	—	—	—	—	—	—	VIM1	—	—	—

# 2007 Vehicles

vehicle	Freestar	Freestyle	Fusion	Fusion	F-S, S-D	F-S, S-D	F-S, S-D	Grand Mar	Mariner	Mariner	Mariner
engine	4.2L	3.0L	2.3 L	3.0L	5.4 L	6.0L	6.8 L	4.6 L	2.3L	3.0L	2.3 L
modifier							Diesel				Hybrid

LTM	Liftgate / Trunk Module	VIM1	—	—	—	—	—	—	—	—	—	—
MCM	Message Center Module	—	—	—	—	—	—	—	VIM1	—	—	—
NAV	Navigation Module	—	—	—	—	—	—	—	—	—	—	—
NGSC	Next Generation Speed Control	VIM1	—	—	—	—	—	—	—	—	—	—
OCS / SWS	Occupant Classification Sensor Module	—	—	CAN	CAN	—	—	—	—	—	—	—
PAM	Parking Aid Module	VIM1	VIM1	—	—	VIM1	VIM1	VIM1	—	VIM1	VIM1	VIM1
PATS	Passive Anti - Theft Module	—	—	—	—	—	—	—	—	—	—	—
PCSM	Passenger Climate Seat Module	VIM1	—	—	—	—	—	—	—	—	—	—
PRB	Power Running Board	—	—	—	—	—	—	—	—	—	—	—
PSCM	Power Steering Control Module	—	—	—	—	—	—	—	—	—	—	CAN
PSD1	Right Power Sliding Door Module	VIM1	—	—	—	—	—	—	—	—	—	—
PSD2	Left Power Sliding Door Module	VIM1	—	—	—	—	—	—	—	—	—	—
RAP	Remote Anti - Theft Module	—	—	—	—	—	—	—	—	—	—	—
RASM	Rear Air Suspension Module	—	—	—	—	—	—	—	CAN	—	—	—
RATC	Rear Air Temp Dontrol	—	—	—	—	—	—	—	—	—	—	—
RCM	Restraint Control Module	VIM1	CAN	CAN	CAN	VIM1	VIM1	VIM1	VIM1	VIM1	VIM1	VIM1
REM	Rear Electronics Module	—	—	—	—	—	—	—	—	—	—	—
RESC	Remote Emergency Satellite Unit	—	—	—	—	—	—	—	—	—	—	—
RETM / RSE	Rear Entertainment Module	—	CAN	—	—	—	—	—	—	—	—	—
SASM	Steering Angle Sensor Module	—	—	—	—	—	—	—	—	—	—	—
SDAR	Satellite Digital Audio Receiver	—	CAN	CAN	CAN	—	—	—	—	—	—	—
TBC	Trailer Brake Control Module	—	—	—	—	CAN	CAN	CAN	—	—	—	—
TCM	Transmission / Transaxle Control Module	—	CAN	CAN	CAN	—	CAN	—	—	—	—	CAN
VAPS	Variable Assist Power Steering	—	—	—	—	—	—	—	—	—	—	—
VDM	Vehicle Dynamics Module	—	—	—	—	—	—	—	—	—	—	—
VSM / BSM	Vehicle / Body Security Module	—	—	—	—	VIM1	VIM1	VIM1	—	—	—	—
_4X4	4X4 Control Module	—	CAN	CAN	CAN	VIM1	VIM1	VIM1	—	CAN	CAN	CAN





# 2007 Vehicles

vehicle	Mark LT	Milan	Milan	MKX	MKZ	MKZ	Montego	Monterey	Mtneer	Mtneer	Mustang
engine	5.4 L	2.3 L	3.0 L	3.5L	3.0 L	3.5 L	3.0 L	4.2 L	4.0 L	4.6 L	4.0 L
modifier	Lincoln										

LTM	Liftgate / Trunk Module	—	—	—	CAN	—	—	—	VIM1	—	—	—
MCM	Message Center Module	—	—	—	—	—	—	—	—	—	—	—
NAV	Navigation Module	—	—	—	—	—	—	—	—	—	—	—
NGSC	Next Generation Speed Control	—	—	—	—	—	—	—	VIM1	—	—	—
OCS / SWS	Occupant Classification Sensor Module	—	CAN	CAN	CAN	CAN	CAN	—	—	CAN	CAN	—
PAM	Parking Aid Module	VIM1	—	—	CAN	—	—	VIM1	VIM1	—	CAN	—
PATS	Passive Anti - Theft Module	—	—	—	—	—	—	—	—	—	—	—
PCSM	Passenger Climate Seat Module	—	—	—	CAN	—	—	—	VIM1	—	—	—
PRB	Power Running Board	—	—	—	—	—	—	—	—	—	CAN	—
PSCM	Power Steering Control Module	—	—	—	—	—	—	—	—	—	—	—
PSD1	Right Power Sliding Door Module	—	—	—	—	—	—	—	VIM1	—	—	—
PSD2	Left Power Sliding Door Module	—	—	—	—	—	—	—	VIM1	—	—	—
RAP	Remote Anti - Theft Module	—	—	—	—	—	—	—	—	—	—	—
RASM	Rear Air Suspension Module	—	—	—	—	—	—	—	—	—	—	—
RATC	Rear Air Temp Dontrol	—	—	—	—	—	—	—	—	—	—	—
RCM	Restraint Control Module	VIM1	CAN	CAN	CAN	CAN	CAN	CAN	VIM1	CAN	CAN	VIM1
REM	Rear Electronics Module	—	—	—	—	—	—	—	—	—	—	—
RESC	Remote Emergency Satellite Unit	—	—	—	—	—	—	—	—	—	—	—
RETM / RSE	Rear Entertainment Module	CAN	—	—	DVD-CAN	—	—	CAN	—	—	CAN	—
SASM	Steering Angle Sensor Module	—	—	—	CAN	—	—	—	—	—	—	—
SDAR	Satellite Digital Audio Receiver	CAN	CAN	CAN	CAN	—	—	CAN	—	—	CAN	CAN
TBC	Trailer Brake Control Module	—	—	—	—	—	—	—	—	—	—	—
TCM	Transmission / Transaxle Control Module	—	CAN	CAN	—	CAN	CAN	CAN	—	—	CAN	—
VAPS	Variable Assist Power Steering	—	—	—	—	—	—	—	—	—	—	—
VDM	Vehicle Dynamics Module	—	—	—	—	—	—	—	—	—	—	—
VSM / BSM	Vehicle / Body Security Module	VIM1	—	—	—	—	—	—	—	—	—	—
_4X4	4X4 Control Module	CAN	CAN	CAN	CAN	—	—	CAN	—	—	CAN	—



# 2007 Vehicles

vehicle	Mustang	Mustang	Navigator	Ranger	Ranger	Ranger	Taurus	Town Car
engine	4.6 L	5.4 L	5.4 L	2.3L	3.0 L	4.0 L	3.0 L	4.6 L
modifier								

LTM	Liftgate / Trunk Module	—	—	CAN	—	—	—	—	VIM1
MCM	Message Center Module	—	—	—	—	—	—	—	CAN
NAV	Navigation Module	—	—	—	—	—	—	—	VIM1
NGSC	Next Generation Speed Control	—	—	—	—	—	—	—	—
OCS / SWS	Occupant Classification Sensor Module	—	—	—	CAN	CAN	CAN	—	—
PAM	Parking Aid Module	—	—	CAN	—	—	—	—	VIM1
PATS	Passive Anti - Theft Module	—	—	—	—	—	—	—	—
PCSM	Passenger Climate Seat Module	—	—	—	—	—	—	—	—
PRB	Power Running Board	—	—	CAN	—	—	—	—	—
PSCM	Power Steering Control Module	—	—	—	—	—	—	—	—
PSD1	Right Power Sliding Door Module	—	—	—	—	—	—	—	—
PSD2	Left Power Sliding Door Module	—	—	—	—	—	—	—	—
RAP	Remote Anti - Theft Module	—	—	—	—	—	—	—	—
RASM	Rear Air Suspension Module	—	—	—	—	—	—	—	—
RATC	Rear Air Temp Dontrol	—	—	—	—	—	—	—	VIM1
RCM	Restraint Control Module	VIM1	VIM1	CAN	CAN	CAN	CAN	VIM1	VIM1
REM	Rear Electronics Module	—	—	—	—	—	—	—	—
RESC	Remote Emergency Satellite Unit	—	—	—	—	—	—	—	—
RETM / RSE	Rear Entertainment Module	—	—	CAN	—	—	—	—	—
SASM	Steering Angle Sensor Module	—	—	—	—	—	—	—	—
SDAR	Satellite Digital Audio Receiver	CAN	CAN	CAN	CAN	CAN	CAN	—	—
TBC	Trailer Brake Control Module	—	—	—	—	—	—	—	—
TCM	Transmission / Transaxle Control Module	—	—	CAN	—	—	—	—	—
VAPS	Variable Assist Power Steering	—	—	—	—	—	—	—	—
VDM	Vehicle Dynamics Module	—	—	CAN	—	—	—	—	CAN
VSM / BSM	Vehicle / Body Security Module	—	—	—	—	—	—	—	—
_4X4	4X4 Control Module	—	—	CAN	CAN	CAN	CAN	—	—





# 2008 Vehicles

vehicle	Explorer SpTrac	Explorer SpTrac	F - 150	F - 150	F - 150	F650/750	F650/750	F-800	Focus	Fusion	Fusion	Fusion	F-S, S-D
engine	4.0 L	4.6 L	4.2 L	4.6 L	5.4 L	6.0 L	7.2L	5.9 L	2.0 L	2.3 L	3.0 L	5.4 L	
modifier						Diesel	Cat	Cummins					

PCM	Powertrain Control Module	CAN	CAN	CAN	CAN	CAN	—	—	—	CAN	CAN	CAN	CAN
ABS	Anti - lock Brake Module	CAN	CAN	CAN	CAN	CAN	CAN	CAN	CAN	CAN	CAN	CAN	CAN
ABS / RSC	ABS / Roll Stability Control	—	—	—	—	—	—	—	—	—	—	—	—
ACM	Audio Control Module	CAN	CAN	CAN	CAN	CAN	—	—	—	—	CAN	CAN	CAN
ACMN	ACM / Navigation	—	—	CAN	MS CAN	CAN	—	—	—	—	—	—	—
ACP	Audio Control Protocol Gateway Module	—	—	—	—	—	—	—	—	—	—	—	—
APIM	Accessory Protocol Interface Module	CAN	CAN	—	—	—	—	—	—	—	—	—	—
ASM	Air Suspension Module (4 wheel)	—	—	—	—	—	—	—	—	—	—	—	—
BCM/TBCM	Battery Control Module	—	—	—	—	—	—	—	—	—	—	—	—
BSCM	Brake System Control Module	—	—	—	—	—	—	—	—	—	—	—	—
CCSM	Climate Control Seat Module	—	—	—	—	—	—	—	—	—	—	—	—
CVT	Continuously Variable Transmission	—	—	—	—	—	—	—	—	—	—	—	—
DATC	Dual Elec Auto Temp Ctrl Mod	—	—	—	—	—	—	—	—	—	—	—	—
DCSM	Driver Climate Seat Module	—	—	—	—	—	—	—	—	—	—	—	—
DDM	Driver Door Module	—	—	—	—	—	—	—	—	—	—	—	—
DEM	Differential Control Module	—	—	—	—	—	—	—	—	—	—	—	—
DSM	Driver Seat Module	—	CAN	CAN	CAN	CAN	—	—	—	—	—	—	CAN
DSP	Digital Signal Processing Module	—	—	—	—	—	—	—	—	—	—	—	—
EATC	Electronic Auto Temp Control	—	—	—	—	—	—	—	—	—	CAN	CAN	—
EMTC	Electronic Manual Temp Control	—	—	—	—	—	—	—	—	—	—	—	—
EPB	Electronic Parking Brake Module	—	—	—	—	—	—	—	—	—	—	—	—
FCIM	Front Controls Interface Module	—	—	—	—	—	—	—	—	—	—	—	—
FDIM	Front Display Interface Module	—	—	—	—	—	—	—	—	—	—	—	—
FEM	Front Electronic Module	—	—	—	—	—	—	—	—	—	—	—	—
FICM	Fuel Injector Control Module	—	—	—	—	—	—	—	—	—	—	—	—
FSSM	Fire Supression Module	—	—	—	—	—	—	—	—	—	—	—	—
GEM (SJB)	Generic Electronic Module	CAN	CAN	—	—	—	VIM 1	VIM 1	VIM 1	CAN	CAN	CAN	CAN
HCM	Headlamp Control Module	—	—	—	—	—	—	—	—	—	—	—	—
HEC	Hybrid Electronic Cluster	—	—	CAN	CAN	CAN	—	—	—	—	—	—	—
HVAC	Heating Ventilation Air Conditioning	CAN	CAN	CAN	CAN	CAN	—	—	—	—	—	—	CAN
ICM	Instrument Cluster Mudule	CAN	CAN	CAN	CAN	CAN	—	—	—	CAN	CAN	CAN	CAN

# 2008 Vehicles

		vehicle	Explorer SpTrac	Explorer SpTrac	F - 150	F - 150	F - 150	F650/750	F650/750	F-800	Focus	Fusion	Fusion	F-S, S-D
		engine	4.0 L	4.6 L	4.2 L	4.6 L	5.4 L	6.0 L	7.2L	5.9 L	2.0 L	2.3 L	3.0 L	5.4 L
		modifier						Diesel	Cat	Cummins				
ITCCM	Intelligent Torque Control Coupling Module	—	—	—	—	—	—	—	—	—	—	—	—	—
LCM	Lighting Control Module	—	—	—	—	—	—	—	—	—	—	—	—	—
LTM	Liftgate / Trunk Module	—	—	—	—	—	—	—	—	—	—	—	—	—
MCM	Message Center Module	—	—	—	—	—	—	—	—	—	—	—	—	—
NAV	Navigation Module	—	—	—	—	—	—	—	—	—	—	—	—	—
NGSC	Next Generation Speed Control	—	—	—	—	—	—	—	—	—	—	—	—	—
OCS / SWS	Occupant Classification Sensor Module	CAN	CAN	—	—	—	—	—	—	—	CAN	CAN	CAN	—
PAM	Parking Aid Module	—	CAN	VIM 1	VIM 1	VIM 1	—	—	—	—	—	—	—	VIM 1
PATS	Passive Anti - Theft Module	—	—	—	—	—	—	—	—	—	—	—	—	—
PCSM	Passenger Climate Seat Module	—	—	—	—	—	—	—	—	—	—	—	—	—
PRB	Power Running Board	—	—	—	—	—	—	—	—	—	—	—	—	—
PSCM	Power Steering Control Module	—	—	—	—	—	—	—	—	—	—	—	—	—
PSD1	Right Power Sliding Door Module	—	—	—	—	—	—	—	—	—	—	—	—	—
PSD2	Left Power Sliding Door Module	—	—	—	—	—	—	—	—	—	—	—	—	—
RAP	Remote Anti - Theft Module	—	—	—	—	—	—	—	—	—	—	—	—	—
RASM	Rear Air Suspension Module	—	—	—	—	—	—	—	—	—	—	—	—	—
RATC	Rear Air Temp Control	—	—	—	—	—	—	—	—	—	—	—	—	—
RCM	Restraint Control Module	CAN	CAN	VIM 1	VIM 1	VIM 1	—	—	—	—	CAN	CAN	CAN	CAN
RCU	Audio Rear Control Unit	—	—	—	—	—	—	—	—	—	—	—	—	—
REM	Rear Electronics Module	—	—	—	—	—	—	—	—	—	—	—	—	—
RESC	Remote Emergency Satellite Unit	—	—	—	—	—	—	—	—	—	—	—	—	—
RETM / RSE	Rear Entertainment Module	CAN	CAN	CAN	CAN	CAN	—	—	—	—	—	—	—	CAN
SASM	Steering Angle Sensor Module	—	—	—	—	—	—	—	—	—	—	—	—	—
SDAR	Satellite Digital Audio Receiver	—	CAN	CAN	CAN	CAN	—	—	—	—	—	CAN	CAN	CAN
SECM	Steering Effort Control	—	—	—	—	—	—	—	—	—	—	—	—	—
TBC	Trailer Brake Control Module	—	—	—	—	—	—	—	—	—	—	—	—	CAN
TCM	Transmission / Transaxle Control Module	—	CAN	—	—	—	—	—	—	—	—	CAN	CAN	—
VAPS	Variable Assist Power Steering	—	—	—	—	—	—	—	—	—	—	—	—	—
VDM	Vehicle Dynamics Module	—	—	—	—	—	—	—	—	—	—	—	—	—
VSM / BSM	Vehicle / Body Security Module	—	—	CAN	CAN	CAN	—	—	—	—	—	—	—	CAN
_4X4	4X4 Control Module	—	CAN	CAN	CAN	CAN	—	—	—	—	—	CAN	CAN	VIM 1















# 2009 Vehicles

	vehicle	Explorer SpTrac	Explorer SpTrac	F - 150	F - 150	F - 150	F650/750	F650/750	F-800	Flex	Focus	Fusion	Fusion	F-S, S-D
	engine	4.0 L	4.6 L	4.2 L	4.6 L	5.4 L	6.0 L	7.2L	5.9 L	3.5L	2.0 L	2.3 L	3.0 L	5.4 L
	modifier						Diesel	Cat	Cummins					
PCM	Powertrain Control Module	CAN	CAN	CAN	CAN	CAN	—	—	—	CAN	CAN	CAN	CAN	CAN
ABS	Anti - lock Brake Module	CAN	CAN	CAN	CAN	CAN	CAN	CAN	CAN	CAN	CAN	CAN	CAN	CAN
ABS / RSC	ABS / Roll Stability Control	—	—	—	—	—	—	—	—	—	—	—	—	—
ACM	Audio Control Module	CAN	CAN	CAN	CAN	CAN	—	—	—	—	CAN	CAN	CAN	CAN
ACMN	ACM / Navigation	—	—	CAN	CAN	CAN	—	—	—	—	—	—	—	—
ACP	Audio Control Protocol Gateway Module	—	—	—	—	—	—	—	—	—	—	—	—	—
APIM	Accessory Protocol Interface Module	—	—	—	—	—	—	—	—	—	—	—	—	—
ASM	Air Suspension Module (4 wheel)	—	—	—	—	—	—	—	—	—	—	—	—	—
BCM/TBCM	Battery Control Module	—	—	—	—	—	—	—	—	—	—	—	—	—
BSCM	Brake System Control Module	—	—	—	—	—	—	—	—	—	—	—	—	—
CCSM	Climate Control Seat Module	—	—	—	—	—	—	—	—	—	—	—	—	—
CVT	Continuously Variable Transmission	—	—	—	—	—	—	—	—	—	—	—	—	—
DATC	Dual Elec Auto Temp Ctrl Mod	—	—	—	—	—	—	—	—	—	—	—	—	—
DCSM	Driver Climate Seat Module	—	—	—	—	—	—	—	—	—	—	—	—	—
DDM	Driver Door Module	—	—	—	—	—	—	—	—	—	—	—	—	—
DEM	Differential Control Module	—	—	—	—	—	—	—	—	—	—	—	—	—
DSM	Driver Seat Module	CAN	CAN	—	—	—	—	—	—	CAN	—	—	—	CAN
DSP	Digital Signal Processing Module	—	—	—	—	—	—	—	—	—	—	—	—	—
EATC	Electronic Auto Temp Control	CAN	CAN	—	—	—	—	—	—	—	CAN	CAN	CAN	CAN
EMTC	Electronic Manual Temp Control	—	—	—	—	—	—	—	—	—	—	—	—	—
EPB	Electronic Parking Brake Module	—	—	—	—	—	—	—	—	—	—	—	—	—
FCIM	Front Controls Interface Module	—	—	—	—	—	—	—	—	—	—	—	—	—
FDIM	Front Display Interface Module	—	—	—	—	—	—	—	—	—	—	—	—	—
FEM	Front Electronic Module	—	—	—	—	—	—	—	—	—	—	—	—	—
FICM	Fuel Injector Control Module	—	—	—	—	—	—	—	—	—	—	—	—	—
FSSM	Fire Supression Module	—	—	—	—	—	—	—	—	—	—	—	—	—
GEM (SJB)	Generic Electronic Module	CAN	CAN	CAN	CAN	CAN	VIM 1	VIM 1	VIM 1	CAN	CAN	CAN	CAN	CAN
HCM	Headlamp Control Module	—	—	—	—	—	—	—	—	—	—	—	—	—
HEC	Hybrid Electronic Cluster	—	—	CAN	CAN	CAN	—	—	—	—	—	—	—	—
HVAC	Heating Ventilation Air Conditioning	CAN	CAN	—	—	—	—	—	—	—	CAN	CAN	CAN	CAN
ICM	Instrument Cluster Mudule	CAN	CAN	CAN	CAN	CAN	—	—	—	CAN	CAN	CAN	CAN	CAN

# 2009 Vehicles

	vehicle	Explorer SpTrac	Explorer SpTrac	F - 150	F - 150	F - 150	F650/750	F650/750	F-800	Flex	Focus	Fusion	Fusion	F-S, S-D
	engine	4.0 L	4.6 L	4.2 L	4.6 L	5.4 L	6.0 L	7.2L	5.9 L	3.5L	2.0 L	2.3 L	3.0 L	5.4 L
	modifier						Diesel	Cat	Cummins					
ITCCM	Intelligent Torque Control Coupling Module	—	—	—	—	—	—	—	—	—	—	—	—	—
LCM	Lighting Control Module	—	—	—	—	—	—	—	—	—	—	—	—	—
LTM	Liftgate / Trunk Module	—	—	—	—	—	—	—	—	CAN	—	—	—	—
MCM	Message Center Module	—	—	—	—	—	—	—	—	—	—	—	—	—
NAV	Navigation Module	—	—	—	—	—	—	—	—	—	—	—	—	—
NGSC	Next Generation Speed Control	—	—	—	—	—	—	—	—	—	—	—	—	—
OCS / SWS	Occupant Classification Sensor Module	CAN	CAN	—	—	—	—	—	—	CAN	CAN	—	—	—
PAM	Parking Aid Module	CAN	CAN	—	—	—	—	—	—	—	—	CAN	CAN	VIM 1
PATS	Passive Anti - Theft Module	—	—	—	—	—	—	—	—	—	—	—	—	—
PCSM	Passenger Climate Seat Module	—	—	—	—	—	—	—	—	—	—	—	—	—
PRB	Power Running Board	—	—	CAN	CAN	CAN	—	—	—	—	—	—	—	—
PSCM	Power Steering Control Module	—	—	—	—	—	—	—	—	—	—	—	—	—
PSD1	Right Power Sliding Door Module	—	—	—	—	—	—	—	—	—	—	—	—	—
PSD2	Left Power Sliding Door Module	—	—	—	—	—	—	—	—	—	—	—	—	—
RAP	Remote Anti - Theft Module	—	—	—	—	—	—	—	—	—	—	—	—	—
RASM	Rear Air Suspension Module	—	—	—	—	—	—	—	—	—	—	—	—	—
RATC	Rear Air Temp Control	—	—	—	—	—	—	—	—	—	—	—	—	—
RCM	Restraint Control Module	CAN	CAN	—	—	—	—	—	—	CAN	CAN	CAN	CAN	CAN
RCU	Audio Rear Control Unit	—	—	—	—	—	—	—	—	—	—	—	—	—
REM	Rear Electronics Module	—	—	—	—	—	—	—	—	—	—	—	—	—
RESC	Remote Emergency Satellite Unit	—	—	—	—	—	—	—	—	—	—	—	—	—
RETM / RSE	Rear Entertainment Module	CAN	CAN	CAN	CAN	CAN	—	—	—	CAN	—	—	—	CAN
SASM	Steering Angle Sensor Module	—	—	—	—	—	—	—	—	—	—	—	—	—
SDAR	Satellite Digital Audio Receiver	—	—	CAN	CAN	CAN	—	—	—	—	—	CAN	CAN	CAN
SECM	Steering Effort Control	—	—	—	—	—	—	—	—	—	—	—	—	—
TBC	Trailer Brake Control Module	—	—	CAN	CAN	CAN	—	—	—	—	—	—	—	CAN
TCM	Transmission / Transaxle Control Module	—	CAN	CAN	CAN	CAN	—	—	—	—	—	CAN	CAN	—
VAPS	Variable Assist Power Steering	—	—	—	—	—	—	—	—	—	—	—	—	—
VDM	Vehicle Dynamics Module	—	—	—	—	—	—	—	—	—	—	—	—	—
VSM / BSM	Vehicle / Body Security Module	—	—	CAN	CAN	CAN	—	—	—	—	—	—	—	CAN
_4X4	4X4 Control Module	—	CAN	CAN	CAN	CAN	—	—	—	CAN	—	CAN	CAN	VIM 1

# 2009 Vehicles

	vehicle	F-S, S-D	F-S, S-D	Ford Motor Home	Grand Mar	Mariner	Mariner	Mariner	Mark LT	Milan	Milan	MKS	MKX	MKZ
	engine	6.4L	6.8 L	6.8L	4.6 L	2.3L	3.0L	2.3 L	5.4 L	2.3 L	3.0 L	3.7L	3.5L	3.5 L
	modifier	Diesel						Hybrid	Lincoln					
PCM	Powertrain Control Module	CAN	CAN	CAN	CAN	CAN	CAN	CAN	CAN	CAN	CAN	CAN	CAN	CAN
ABS	Anti - lock Brake Module	CAN	CAN	VIM 1	CAN	CAN	CAN	CAN	CAN	CAN	CAN	CAN	CAN	CAN
ABS / RSC	ABS / Roll Stability Control	—	—	—	—	—	—	—	—	—	—	—	—	—
ACM	Audio Control Module	CAN	CAN	—	—	CAN	CAN	CAN	CAN	CAN	CAN	—	CAN	CAN
ACMN	ACM / Navigation	—	—	—	—	—	—	—	—	—	—	—	CAN	CAN
ACP	Audio Control Protocol Gateway Module	—	—	—	—	—	—	CAN	—	—	—	—	—	—
APIM	Accessory Protocol Interface Module	—	—	—	—	—	—	—	—	—	—	—	—	—
ASM	Air Suspension Module (4 wheel)	—	—	—	—	—	—	—	—	—	—	—	—	—
BCM TBCM	Battery Control Module	—	—	—	—	—	—	CAN	—	—	—	—	—	—
BSCM	Brake System Control Module	—	—	—	—	—	—	CAN	—	—	—	—	—	—
CCSM	Climate Control Seat Module	—	—	—	—	—	—	—	—	—	—	—	—	CAN
CVT	Continuously Variable Transmission	—	—	—	—	—	—	—	—	—	—	—	—	—
DATC	Dual Elec Auto Temp Ctrl Mod	—	—	—	—	—	—	—	—	—	—	—	—	CAN
DCSM	Driver Climate Seat Module	—	—	—	—	—	—	—	—	—	—	—	CAN	—
DDM	Driver Door Module	—	—	—	VIM 1	—	—	—	—	—	—	CAN	—	CAN
DEM	Differential Control Module	—	—	—	—	—	—	—	—	—	—	—	—	—
DSM	Driver Seat Module	CAN	CAN	—	—	—	—	—	CAN	—	—	CAN	CAN	CAN
DSP	Digital Signal Processing Module	—	—	—	—	—	—	—	—	—	—	—	—	—
EATC	Electronic Auto Temp Control	—	—	—	VIM 1	—	—	—	—	CAN	CAN	—	CAN	CAN
EMTC	Electronic Manual Temp Control	—	—	—	—	—	—	—	—	—	—	—	—	—
EPB	Electronic Parking Brake Module	—	—	—	—	—	—	—	—	—	—	—	—	—
FCIM	Front Controls Interface Module	—	—	—	—	CAN	CAN	CAN	—	—	—	—	—	—
FDIM	Front Display Interface Module	—	—	—	—	CAN	CAN	CAN	—	—	—	—	—	—
FEM	Front Electronic Module	—	—	—	—	—	—	—	—	—	—	—	—	—
FICM	Fuel Injector Control Module	—	—	—	—	—	—	—	—	—	—	—	—	—
FSSM	Fire Supression Module	—	—	—	CAN	—	—	—	—	—	—	—	—	—
GEM (SJB)	Generic Electronic Module	CAN	CAN	—	—	CAN	CAN	CAN	—	CAN	CAN	CAN	CAN	CAN
HCM	Headlamp Control Module	—	—	—	—	—	—	—	—	—	—	—	—	—
HEC	Hybrid Electronic Cluster	—	—	—	—	—	—	—	—	—	—	—	—	—
HVAC	Heating Ventilation Air Conditioning	CAN	CAN	—	VIM 1	CAN	CAN	CAN	CAN	CAN	CAN	—	CAN	CAN
ICM	Instrument Cluster Mudule	CAN	CAN	CAN	CAN	CAN	CAN	CAN	CAN	CAN	CAN	—	CAN	CAN











# Using the PATS Programming Chart



**VEHICLE/YEAR:**

The model and manufacture date of the vehicle

- Compare tenth digit of the vehicle's VIN to the VIN Conversion Chart to determine model year

**PATS TYPE:**

The PATS system type for the vehicle

- PATS type I uses IGNITION KEY CODE ERASE option to program
- PATS type II uses ENTER SECURITY ACCESS option to program

**# KEYS MIN:**

The minimum number of keys that must be programmed after all keys are erased

**# KEYS MAX:**

The maximum number of keys that can be stored in the module (except in unlimited key programming)

**MODULE:**

The module that you must select to access the PATS functionality

**STARTER INTERRUPT:**

The starter will not engage with an unprogrammed key if the vehicle is equipped with the starter interrupt feature

**UNLIMITED KEY PROGRAMMING:**

If this feature is enabled (by NGS), the # KEYS MAX is not limited to 8

**KEY BLANKS:**

Only use Ford qualified keys for PATS equipped vehicles:

- Ford Rotunda
- Strattec
- Ilco
- Curtis
- Huf
- Valeo

For valet key blanks, please refer to the Rotunda catalog.

**Programming**

*Note: When testing CAN vehicles with NGS XLC and NGS XLC Locksmith, make sure to use the CAN VIM and software.*

1. Locate the vehicle model and year in the chart.
2. Determine the PATS system type for the vehicle you are testing.
3. Select a key programming procedure based on your vehicle's system type (certain procedures are limited to specific system types).
4. Follow the instructions to create the keys you need
  - Note starter interrupt and unlimited key programming information before programming.

**Vin Conversion Chart**

VIN (10 <sup>th</sup> digit)	Model Year	VIN (10 <sup>th</sup> digit)	Model Year
9	2009	T	1996
8	2008	S	1995
7	2007	R	1994
6	2006	R	1994
5	2005	P	1993
4	2004	N	1992
3	2003	M	1991
2	2002	L	1990
1	2001	K	1989
Y	2000	J	1988
X	1999	H	1987
W	1998	G	1986
V	1997	F	1985
		E	1984

## 2009 PATS Programming Chart

Vehicle	Notes	Year (vin)	Build date	Module	Pats type	# Keys		Starter interrupt?	Unlim key prog?	Key blank		
						Min	Max			Strattec	Rotunda	llco/jet
Aviator	Lincoln (Explorer)	03 - 05		PCM	II	2	8	yes	yes	691259	164-R0463	NA
Blackwood	Lincoln	02 - 03		HEC	II	2	8	no	no	598333	011-R0232	H72
Continental	Lincoln	98 - 02		VIC	II	2	8	no	no	598333	011-R0232	H 72
Contour	optional in V6 only		97 - 2/1/98	PATS	I	1	16	yes	no	NA	011-R0225	H 73
			2/2/98 - 00	PCM	II	2	8					
Cougar	Mercury	99 - 02		PCM	II	2	8	yes	no	NA	011-R0235	H 73
Crown Victoria		98 - 02		PATS	II	2	8	no	no	598333	011-R0221	H 72
		03 - 04		PCM				yes	yes	599114	164-R0475	NA
		05 - 09		PCM CAN								
E-Series Trucks		08 - 09		ICM CAN	II	2	8	yes	yes	692813	164-R7016	NA
Edge		07 - 09		ICM CAN	II	2	8	yes	yes	692813	164-R7016	NA
Escape (Tribute)*	except hybrid	01 - 04		PCM	II	2	8	yes	no	691643	011-R0250	H 86
		05 - 07		PCM CAN								
		08		iICM CAN								
	HEV	06 - 07		PCM CAN				no	yes	599114	164-R0475	NA
		08 - 09		ICM CAN								
Excursion		00 - 05		PATS	II	2	8	no	no	598333	011-R0221	H 72
Expedition	(optional eq)	97 - 98		PATS	I	1	16	no	no	598333	011-R0221	H 72
		99 - 02		HEC	II	2	8					
		03 - 04		PCM								
		05 - 06		PCM CAN								
		07 - 09		ICM CAN								
Explorer	4 door	98 - 01		PATS	II	2	8	no	no	598333	011-R0221	H 72
		02 - 03		PCM				yes	yes	599114	164-R0475	NA
		04 - 05		PCM CAN								
		06 - 09		ICM CAN								
Explorer Sport	2 door		98 - 7/23/00	PATS	II	2	8	no	no	598333	011-R0221	H 72
			7/24/00 - 03	PCM				yes	yes	599114	164-R0475	NA
(Explorer) Sport Trac			before 7/23/00	PATS	II	2	8	no	no	598333	011-R0221	H 72
			7/24/00 - 05	PCM				yes	yes	599114	164-R0475	NA
		07 - 09		ICM CAN								
F - 150 heritage		99 - 04		HEC	II	2	8	no	no	598333	011-R0221	H 72
F - 150	new body	04 - 08		PCM CAN	II	2	8	yes	yes	599114	164-R0475	NA
		09		ICM CAN								
F - 150 (Harley D)		01 - 03		HEC	II	2	8	no	no	NA	164-R0461	H72
		06 - 08		PCM CAN				yes	yes	599114	164-R0475	NA

## 2009 PATS Programming Chart

Vehicle	Notes	Year (vin)	Build date	Module	Pats type	# Keys		Starter interrupt?	Unlim key prog?	Key blank				
						Min	Max			Strattec	Rotunda	Ilco/jet		
F - 250		99 - 01		HEC	II	2	8	no	no	598333	011-R0221	H 72		
F-Series (Super Duty)		08 - 09		ICM	II	2	8	yes	yes	599114	164-R0475	NA		
Flex		09		ICM CAN	II	2	8	yes	—	692395	164-R7013	NA		
Focus		00 - 03		PCM	II	2	8	yes	yes	691643	011-R0250	H 86		
		03 2.3L, 04 - 05		PCM CAN										
		06 - 07								ICM CAN	599114	164-R0475	NA	
		08 - 09												
Ford 500		05 - 07		PCM CAN	II	2	8	yes	yes	599114	164-R0475	NA		
Ford GT		05 - 06		PATS	II	2	8	no	no	598333		H72		
Freestar		04 - 05		PCM	II	2	8	yes	yes	599114	164-R0475	NA		
		06 - 07		PCM CAN										
Freestyle		05 - 07		PCM CAN	II	2	8	yes	yes	599114	164-R0475	NA		
Fusion		06 - 09		ICM CAN	II	2	8	yes	yes	692395	164-R7013	NA		
Grand Marquis	Mercury	98 - 02		PATS	II	2	8	no	no	598333	011-R0222	H 72		
		03 - 04		PCM										
		05 - 09		PCM CAN						yes	yes	599179	164-R0455	NA
LS	Lincoln	00 - 02		ICM	II	2	8	yes	no	691643	164-R0458	H 74		
		03 - 06							yes					
		07							ICM CAN	691259	164-R0463	NA		
Mariner	Mercury	05 - 07		PCM CAN	II	2	8	yes	yes	599179	164-R0455	NA		
		08 - 09		ICM CAN						692811	164-R7014			
Mariner HEV	Mercury	08 - 09		ICM CAN	II	2	8	no	yes	692811	164-R7014	NA		
Mark LT	Lincoln black F 150	06 - 08		PCM CAN	II	2	8	yes	yes	691259	164-R0463	NA		
Mark VIII	Lincoln	97 - 98		SCIL	I	2	16	yes	no	691641	164-R0467	NA		
Milan	Mercury	06 - 09		ICM CAN	II	2	8	yes	yes	692811	164-R7014	NA		
MKX	Lincoln	07-09		ICM CAN	II	2	8	yes	yes	693356	164-R7015	NA		
MKZ	Lincoln	07-09		ICM CAN	II	2	8	yes	yes	693356	164-R7015	NA		
Montego	Mercury	05 - 07		PCM CAN	II	2	8	yes	yes	599179	164-R0455	NA		
Monterey	Mercury	04 - 05		PCM	II	2	8	yes	yes	599179	164-R0455	NA		
		06 - 07		PCM CAN										
Mountaineer	Mercury 4 door	98 - 01		PATS	II	2	8	no	no	598333	011-R0222	H 72		
		02 - 03		PCM										
		04 - 05		PCM CAN						yes	yes	599179	164-R0455	NA
		06 - 09		ICM CAN										

## 2009 PATS Programming Chart

Vehicle	Notes	Year (vin)	Build date	Module	Pats type	# Keys		Starter interrupt?	Unlim key prog?	Key blank								
						Min	Max			Strattec	Rotunda	Ilco/jet						
Mustang	(optional eq)	96		PATS	I	1	16	no	no	NA	011-R0225	H 73						
		96 - 97								598333	011-R0221	H72						
		98		HEC	II	2	8			yes	yes	599114	164-R0475	NA				
		99 - 04										599114	164-R0475	NA				
05 - 09	PCM CAN																	
Mystique	Mercury		97 - 2/1/98	PATS	I	1	16	yes	no			NA	011-R0235	H 73				
	optional in V6 only		2/2/98 - 00	PCM	II	2	8											
Navigator	Lincoln	98		PATS	I	1	16	no	no	598333	011-R0232	H 72						
		99 - 02		HEC														
		03 - 04		PCM	II	2	8						yes	yes	691259	164-R0463	NA	
		05 - 06		PCM CAN														
		07 - 08		ICM CAN														
		09		ICM CAN														II
Ranger (B - Series)*	3L.& 4L.only	99 - 00		PATS	II	2	8	yes	yes	599114	164-R0454	NA						
		01 - 04		PCM														
	3L.& 4L.only	06		PCM CAN														
		07 - 09		ICM CAN									NA	NA				
Sable	(optional eq)	96 - 97		PATS	I	1	16	no	no	598333	011-R0222	H 72						
		98 - 99																
	Mercury	00 - 03		PCM	II	2	8						yes	yes	599179	164-R0455	NA	
		04 - 05																PCM CAN
		08-09																ICM CAN
Taurus	(optional eq)	96 - 97		PATS	I	1	16	no	no	598333	011-R0221	H 72						
		98 - 99																
		00 - 03		PCM	II	2	8						yes	yes	599114	164-R0475	NA	
		04 - 06																PCM CAN
		08 - 09																ICM CAN
Taurus X		08 - 09	ICM CAN	II	2	8	yes	yes	682814	164-R8016	NA							
T'Bird Roadster		02		ICM	II	2	8	yes	no	691643	164-R0460	H 74						
		03 - 05																
		06		ICM CAN														
Town Car	Lincoln	98 - 02		HEC	II	2	8	no	no	598333	011-R0236	H 72						
		03 - 04		PCM														
		05 - 09		PCM CAN									yes	yes	691259	164-R0463	NA	
Windstar		99 - 00		ICM	II	2	8	yes	no	598333	011-R0221	H 72						
		01 - 03		PCM									yes	yes	599114	164-R0475	NA	
Zephyr	Lincoln	06		ICM CAN	II	2	8	yes	yes	691259	164-R7002	NA						

# RKE Transmitter Programming

## Introduction

The Ford Remote Keyless Entry (RKE) system consists of a key ring transmitter (key fob), and in some vehicles, a five-button keypad on the driver's door.

By pressing a button on the key fob, or a series of buttons on the keypad, a programmed code is transmitted to a receiver in the vehicle. This allows owners access to their vehicle without the need for keys.

This section provides the procedures for the following:

- Remote keyless entry transmitter programming.
- Remote keypad factory code retrieval using an NGS XL.

## General Guidelines

When performing any of the procedures in this section, keep the following in mind:

- If a transmitter is operated within 50 meters of a vehicle that is in program mode, it may accidentally become programmed to that vehicle.
- Only entering program mode on one vehicle at a time avoids cross programming the transmitters.
- Reprogramming a transmitter is not necessary if the battery is replaced, any of the buttons are operating properly, or for poor range performance.
- 2002 (or newer) Model Year remote transmitters with the Ford Motor Company name on the back are not backwards compatible with older model year remotes. Although the transmitters might program, they may operate intermittently.

## Before You Begin

Before you begin this procedure check for the following:

- Verify that all of the remote transmitters are present. Any transmitters that are not programmed at this time will no longer work with the vehicle. Once in program mode, all previously stored transmitter IDs are permanently erased.
- To enter program mode, the vehicle must be electronically unlocked/disarmed first.

## RKE Transmitter Programming Procedures

The method used for programming varies depending on the type of vehicle and model year. To determine the correct method for a particular vehicle:

1. Locate the vehicle make and model year in the **Programming Method Charts**.
2. Follow the instructions for the recommend method on the **Procedure Charts**.

## RKE Transmitter Programming Procedure Chart Methods A – C

METHOD	PROCEDURE
<b>A</b>	<ol style="list-style-type: none"> <li>1. Within 10 seconds, turn the key from <b>OFF</b> to <b>RUN</b> 8 times. Make sure to end in <b>RUN</b>. All doors lock and unlock to confirm programming mode.</li> <li>2. Within 20 seconds, press any button on the first remote. The door locks will lock and unlock to confirm programming.</li> <li>3. Repeat step 2 for other transmitters (up to 4).</li> <li>4. Turn the key to <b>OFF</b>; the locks cycle to indicate end of programming.</li> </ol>
<b>B</b>	<ol style="list-style-type: none"> <li>1. Turn the key to <b>RUN</b> or <b>ACCY</b>.</li> <li>2. Momentarily short the pins in the programming connector in the LR quarter panel. All doors lock and unlock to confirm programming mode.</li> <li>3. Press any button on the first remote. The door locks will lock and unlock to confirm programming.</li> <li>4. Repeat step 3 for other transmitters (up to 4).</li> <li>5. Turn the key to <b>OFF</b>; the locks cycle to indicate end of programming.</li> </ol>
<b>C</b>	<ol style="list-style-type: none"> <li>1. Enter the 5 digit factory keypad code into the keypad.</li> <li>2. Within 5 seconds, press the <b>1/2</b> key. All doors lock and unlock to confirm programming mode.</li> <li>3. Within 5 seconds press any button on the first remote. The door locks will lock and unlock to confirm programming.</li> <li>4. Repeat step 3 for other transmitters (up to 4) within 5 seconds.</li> <li>5. To exit the program mode press the <b>7/8</b> and <b>9/0</b> buttons simultaneously.</li> </ol>



## RKE Transmitter Programming

### Procedure Chart

#### Methods D – F

METHOD	PROCEDURE
<b>D</b>	<ol style="list-style-type: none"> <li>1. Within 10 seconds, turn the key from <b>OFF</b> to <b>RUN</b> 5 times. Make sure to end in <b>RUN</b>. All doors lock and unlock to confirm programming mode.</li> <li>2. Within 20 seconds press any button on the first remote. The door locks will lock and unlock to confirm programming.</li> <li>3. Repeat step 2 for other transmitters (up to 4).</li> <li>4. Turn the key to <b>OFF</b>; the locks cycle to indicate end of programming.</li> </ol>
<b>E</b>	<ol style="list-style-type: none"> <li>1. Within 10 seconds, turn the key from <b>OFF</b> to <b>RUN</b> 5 times. Make sure to end in <b>RUN</b>. All doors lock and unlock to confirm programming mode.</li> <li>2. Within 20 seconds press any button on the first remote. The door locks will lock and unlock to confirm programming.</li> <li>3. Repeat step 2 for other transmitters (up to 4).</li> <li>4. Turn the key to <b>OFF</b>; the locks cycle to indicate end of programming.</li> </ol>
<b>F</b>	<ol style="list-style-type: none"> <li>1. Turn the key to <b>RUN</b> or <b>ACCY</b>.</li> <li>2. Short the pins in the programming connector in the base of the steering column. All doors lock and unlock to confirm programming mode.</li> <li>3. Press any button on the first remote. The door locks will lock and unlock to confirm programming.</li> <li>4. Repeat step 3 with other transmitters (up to 4)</li> <li>5. Turn the key to <b>OFF</b>. The locks cycle to indicate end of programming. Remove the short from the programming connector.</li> </ol>

## RKE Transmitter Programming

### Procedure Chart

#### Methods G – I

METHOD	PROCEDURE
<b>G</b>	<ol style="list-style-type: none"> <li>1. Turn the key to <b>RUN</b> or <b>ACCY</b>.</li> <li>2. Momentarily short the pins in the programming connector in the RR quarter panel. All doors lock and unlock to confirm programming mode</li> <li>3. Press any button on the first remote. The door locks will lock and unlock to confirm programming.</li> <li>4. Repeat step 3 for other transmitters (up to 4).</li> <li>5. Turn the key to <b>OFF</b>; the locks cycle to indicate end of programming.</li> </ol>
<b>H</b>	<ol style="list-style-type: none"> <li>1. Turn the key to <b>RUN</b> or <b>ACCY</b>.</li> <li>2. Momentarily short the pins in the programming connector behind the glove box. All doors lock and unlock to confirm programming mode</li> <li>3. Press any button on the first remote. The door locks will lock and unlock to confirm programming.</li> <li>4. Repeat step 3 for other transmitters (up to 4).</li> <li>5. Turn the key to <b>OFF</b>; the locks cycle to indicate end of programming.</li> </ol>
<b>I</b>	<ol style="list-style-type: none"> <li>1. Turn the key to <b>RUN</b> or <b>ACCY</b>.</li> <li>2. Momentarily short the pins in the programming connector behind the glove box. The horn will chirp to confirm programming mode.</li> <li>3. Press any button on the first remote. Horn will chirp to confirm programming</li> <li>4. Repeat step 3 for other transmitters (up to 4).</li> <li>5. Turn the key to <b>OFF</b>; the horn will chirp to indicate end of programming.</li> </ol>

## RKE Transmitter Programming

### Procedure Chart

#### Methods J – L

METHOD	PROCEDURE
<b>J</b>	<ol style="list-style-type: none"> <li>1. Turn the key to <b>RUN</b> or <b>ACCY</b>.</li> <li>2. Momentarily short the pins in the programming connector at the base of the steering column. All doors lock and unlock to confirm programming mode</li> <li>3. Press any button on the first remote. The door locks will lock and unlock to confirm programming.</li> <li>4. Repeat step 3 for other transmitters (up to 4).</li> <li>5. Turn the key to <b>OFF</b>; the locks cycle to indicate end of programming.</li> </ol>
<b>K</b>	<ol style="list-style-type: none"> <li>1. Within 3 seconds, turn the key from <b>OFF</b> to <b>RUN</b> 4 times. Make sure to end in <b>RUN</b>. All doors lock and unlock to confirm programming mode.</li> <li>2. Within 20 seconds, press any button on the first remote. The door locks will lock and unlock to confirm programming.</li> <li>3. Repeat step 2 for other transmitters (up to 4).</li> <li>4. Turn the key to <b>OFF</b>; the locks cycle to indicate end of programming.</li> </ol>
<b>L</b>	<p>Using NGS XL with the Service card:</p> <ol style="list-style-type: none"> <li>1. Select <b>SERVICE BAY FUNCTIONS</b> from the Main menu.</li> <li>2. Select the module (<b>DDM or GEM</b>)</li> <li>3. Select <b>KEY FOB PROGRAMMING</b> for <b>GEM</b> and <b>DDM</b>.</li> <li>4. Select the vehicle year and model and press any button on the first remote.</li> <li>5. Select <b>FOB 1, 2, 3 or 4</b>, then store.</li> <li>6. Repeat above steps for additional transmitters.</li> <li>7. Press <b>CANCEL</b> to quit.</li> <li>8. If transmitters do not work after programming, disconnect the battery from the vehicle for 5 minutes. After the 5 minutes, reconnect the battery and try the transmitters again.</li> </ol>

## RKE Transmitter Programming

### Procedure Chart

#### Methods M – O

METHOD	PROCEDURE
<b>M</b>	<ol style="list-style-type: none"> <li>1. Within 6 seconds, turn the key <b>OFF</b> to <b>RUN</b> 4 times. Make sure to end in <b>OFF</b>. The LED in the clock/trip computer turns on (continuous) to confirm programming mode.</li> <li>2. Within 20 seconds, press any button on the first remote. The LED will flash 4 times to confirm programming.</li> <li>3. Repeat step 2 for other transmitters (up to 4).</li> <li>4. Turn the key to <b>RUN</b>. The LED will turn off to indicate end of programming.</li> </ol>
<b>N</b>	<ol style="list-style-type: none"> <li>1. Enter the vehicle. Close and lock all doors.</li> <li>2. Within 10 seconds, insert and remove the key from the ignition 6 times. When the code is erased, the tail lamps flash.</li> <li>3. Turn the key to <b>ACCY</b>.</li> <li>4. Press any button on the first transmitter. The hazard lamps will flash to confirm programming.</li> <li>5. For additional transmitters, unlock and lock the doors with the driver's door switch.</li> <li>6. Press any button on additional transmitters (up to 4). The hazard lamps will flash to confirm programming</li> <li>7. Open the driver's door and turn the key to <b>OFF</b>.</li> </ol>
<b>O</b>	<ol style="list-style-type: none"> <li>1. Within 6 seconds, turn the key <b>OFF</b> to <b>RUN</b> 4 times. Make sure to end in <b>OFF</b>. The system will chime to confirm programming mode.</li> <li>2. Within 20 seconds, press any button on the first remote. The system will chime once to confirm programming.</li> <li>3. Repeat step 2 for other transmitters (up to 4).</li> <li>4. Turn the key to <b>RUN</b> to exit the programming mode.</li> </ol>

## RKE Transmitter Programming Method Look-up Chart

VEHICLE	Function	MODEL YEAR										MODEL YEAR									
		1992	1993	1994	1995	1996	1997	1998	1998.5	1999	2000	2001	2002	2003	2004	2005	2006	2007	2008	2009	
Aviator	Procedure	- xmitter prog, L use serv card												A	A	A	A	A	A	A	A
	RKE TIC	- FUNCTION TEST - diag card												CSM	CSM	VSM	—	—	—	—	—
	Pad code	- PID data - diag card												CSM	CSM	VSM	—	—	—	—	—
Blackwood	Procedure	—	—	—	—	—	—	—	—	—	—	—	A	A	—	—	—	—	—	—	
	RKE TIC	—	—	—	—	—	—	—	—	—	—	—	RAP	RAP	—	—	—	—	—	—	
	Pad code	—	—	—	—	—	—	—	—	—	—	—	RAP	RAP	—	—	—	—	—	—	
Bronco	Procedure			J	J	J	—	—	—	—	—	—	—	—	—	—	—	—	—	—	
	RKE TIC	—	—				—	—	—	—	—	—	—	—	—	—	—	—	—	—	
	Pad code						—	—	—	—	—	—	—	—	—	—	—	—	—	—	
Continental	Procedure	H	H	H	C	C	C	C	C	A, L - DDM	A, L - DDM	A, L - DDM	A, L - DDM	—	—	—	—	—	—	—	
	RKE TIC	—	—	—	DDM	DDM	DDM	DDM	DDM	DDM	DDM	DDM	DDM	—	—	—	—	—	—	—	
	Pad code	—	—	—	DDM	DDM	DDM	DDM	DDM	DDM	DDM	DDM	DDM	—	—	—	—	—	—	—	
Contour	Procedure	—	—	—	I	I	I	I	I	I	I	—	—	—	—	—	—	—	—	—	
	RKE TIC	—	—	—	—	—	—	—	—	—	—	—	—	—	—	—	—	—	—	—	
	Pad code	—	—	—	—	—	—	—	—	—	—	—	—	—	—	—	—	—	—	—	
Cougar	Procedure		B	B	B	B	B		M	M	M	M	M		—	—	—	—	—	—	
	RKE TIC	—	—	—	—	—	—	—	—	—	—	—	—	—	—	—	—	—	—	—	
	Pad code	—	—	—	—	—	—	—	—	—	—	—	—	—	—	—	—	—	—	—	
Crown Victoria	Procedure	—	H	H	C	C	C	L - DDM	L - DDM	K, L - DDM	K, L - DDM	K, L - DDM	K, L - DDM	K, L - DDM	K, L - DDM	K, A - DDM	A	A	A	A	
	RKE TIC	—	—	—	DDM	DDM	DDM	DDM	DDM	DDM	DDM	DDM	DDM	DDM	DDM	DDM	DDM	DDM	DDM	DDM	
	Pad code	—	—	—	DDM	DDM	DDM	DDM	DDM	DDM	DDM	DDM	DDM	DDM	DDM	DDM	DDM	DDM	DDM	DDM	
Econoline	Procedure	F	F	F	F	F	F	F	F	A, F	A	A	A	A	A	A	A	A	A	A	
	RKE TIC	—	—	—	—	—	—	—	—	—	—	—	—	—	RAP	RAP	RAP	VSM	VSM	VSM	
	Pad code	—	—	—	—	—	—	—	—	—	—	—	—	—	RAP	RAP	RAP	VSM	VSM	VSM	
Edge	Procedure	—	—	—	—	—	—	—	—	—	—	—	—	—	—	—	—	—	***	***	***
	RKE TIC	—	—	—	—	—	—	—	—	—	—	—	—	—	—	—	—	—	—	—	—
	Pad code	—	—	—	—	—	—	—	—	—	—	—	—	—	—	—	—	—	CAN GEM	CAN GEM	CAN GEM
Escape/Tribute/ Hybrid	Procedure	—	—	—	—	—	—	—	—	—	A	A	A, L - GEM	A, L - GEM	A, L - GEM	A	A	A	***	***	
	RKE TIC	***	—	—	—	—	—	—	—	—	—	—	—	—	—	—	—	—	—	—	—
	Pad code	—	—	—	—	—	—	—	—	—	—	—	—	—	—	—	CAN GEM	CAN GEM	CAN GEM	CAN GEM	CAN GEM

CSM / VSM requires UBP cable (H105-00100)

CAN GEM requires Can VIM and MS CAN cable or CAN cable with adapter

\*\*\*Please refer to the vehicle's shop manual for RKE programming procedures

## RKE Transmitter Programming Method Look-up Chart

VEHICLE	Function	MODEL YEAR							MODEL YEAR											
		1992	1993	1994	1995	1996	1997	1998	1998.5	1999	2000	2001	2002	2003	2004	2005	2006	2007	2008	2009
Escort / Tracer Coupe	Procedure	—	—	—	—	—	D	A / D	A	A	A	A	A	A	—	—	—	—	—	—
	RKE TIC	—	—	—	—	—	RAP	RAP	RAP	RAP	RAP	RAP	RAP	RAP	—	—	—	—	—	—
	Pad code	—	—	—	—	—	RAP	RAP	RAP	RAP	RAP	RAP	RAP	RAP	—	—	—	—	—	—
Escort / Tracer Sedan	Procedure	—	—	—	—	—	D	A	A	A	A	A	A	—	—	—	—	—	—	—
	RKE TIC	—	—	—	—	—	RAP	RAP	RAP	RAP	RAP	RAP	RAP	—	—	—	—	—	—	—
	Pad code	—	—	—	—	—	RAP	RAP	RAP	RAP	RAP	RAP	RAP	—	—	—	—	—	—	—
Escort / Tracer Wagon	Procedure	—	—	—	—	—	D	A	A	A	—	—	—	—	—	—	—	—	—	—
	RKE TIC	—	—	—	—	—	RAP	RAP	RAP	RAP	—	—	—	—	—	—	—	—	—	—
	Pad code	—	—	—	—	—	RAP	RAP	RAP	RAP	—	—	—	—	—	—	—	—	—	—
Excursion	Procedure	—	—	—	—	—	—	—	—	—	A	A	A	A	A	A	—	—	—	—
	RKE TIC	—	—	—	—	—	—	—	—	—	—	—	CSM	CSM	CSM	VSM	—	—	—	—
	Pad code	—	—	—	—	—	—	—	—	—	GEM	GEM	CSM	CSM	CSM	VSM	—	—	—	—
Expedition / Expedition EL	Procedure	—	—	—	—	—	D	A	A	A	A	A	A	A	A	A	A	A	A	A
	RKE TIC	—	—	—	—	—	RAP	RAP	RAP	RAP	RAP	RAP	RAP	CSM	CSM	—	—	CAN GEM	CAN GEM	CAN GEM
	Pad code	—	—	—	—	—	RAP	RAP	RAP	RAP	RAP	RAP	RAP	CSM	CSM	—	—	CAN GEM	CAN GEM	CAN GEM
Explorer	Procedure	—	B	B	D	D	D	A	A	A	A	A	A**	A	A	A	A	A	A	A
	RKE TIC	—	—	—	RAP	RAP	RAP	RAP	RAP	RAP	RAP	RAP	CSM	CSM	CSM	VSM	—	—	—	—
	Pad code	—	—	—	RAP	RAP	RAP	RAP	RAP	RAP	RAP	RAP	CSM	CSM	CSM	VSM	CAN GEM	CAN GEM	CAN GEM	CAN GEM
Explorer Sport	Procedure	—	B	B	D	D	D	A	A	A	A	A	A	A	—	—	—	—	—	—
	RKE TIC	—	—	—	RAP	RAP	RAP	RAP	RAP	RAP	RAP	RAP	RAP	RAP	—	—	—	—	—	—
	Pad code	—	—	—	RAP	RAP	RAP	RAP	RAP	RAP	RAP	RAP	RAP	RAP	—	—	—	—	—	—
Explorer Sport Trac	Procedure	—	—	—	—	—	—	—	—	—	—	A	A	A	A	A	A	A	A	A
	RKE TIC	—	—	—	—	—	—	—	—	—	—	RAP	RAP	RAP	RAP	RAP	—	CAN GEM	CAN GEM	CAN GEM
	Pad code	—	—	—	—	—	—	—	—	—	—	RAP	RAP	RAP	RAP	RAP	—	CAN GEM	CAN GEM	CAN GEM
F - Series Trucks (Heritage)	Procedure	—	—	J	J	J	D	A	A	A	A	A	A	A	A	—	—	—	—	—
	RKE TIC	—	—	—	—	—	—	—	—	—	—	RAP	RAP	RAP	RAP	—	—	—	—	—
	Pad code	—	—	—	—	—	RAP	RAP	RAP	RAP	RAP	RAP	RAP	RAP	RAP	—	—	—	—	—
F - Series	Procedure	—	—	—	—	—	—	—	—	—	—	—	—	—	A	A	A	A	A	A
	RKE TIC	—	—	—	—	—	—	—	—	—	—	—	—	—	CSM	VSM	VSM	VSM	VSM	VSM
	Pad code	—	—	—	—	—	—	—	—	—	—	—	—	—	CSM	VSM	VSM	VSM	VSM	VSM

\*\*For 2002 MY (10 digit VIN = 2) with build date prior to March 2002:

1. Without Perimeter anti-theft (or disabled) open the driver's door and (with the door still open) press the interior power door UNLOCK switch.
2. Proceed to the procedure.

CSM / VSM requires UBP cable (H105-00100)

CAN GEM requires Can VIM and MS CAN cable or CAN cable with adapter

\*\*\*Please refer to the vehicle's shop manual for RKE programming procedures

## RKE Transmitter Programming Method Look-up Chart

VEHICLE	Function	MODEL YEAR							MODEL YEAR											
		1992	1993	1994	1995	1996	1997	1998	1998.5	1999	2000	2001	2002	2003	2004	2005	2006	2007	2008	2009
F - Series Super Duty Trucks	Procedure	—	—	J	J	J	J	J	D	D	D	D	A	A	A	A	A	A	A	—
	RKE TIC	—	—	—	—	—	—	—	GEM	GEM	GEM	GEM	CSM	CSM	CSM	VSM	VSM	VSM	VSM	—
	Pad code	—	—	—	—	—	—	—	—	—	—	—	CSM	CSM	CSM	VSM	VSM	VSM	VSM	—
Flex	Procedure	—	—	—	—	—	—	—	—	—	—	—	—	—	—	—	—	—	—	—
	RKE TIC	—	—	—	—	—	—	—	—	—	—	—	—	—	—	—	—	—	—	—
	Pad code	—	—	—	—	—	—	—	—	—	—	—	—	—	—	—	—	—	—	CAN GEM
Focus	Procedure	—	—	—	—	—	—	—	—	O	O	O, L - GEM	O, L - GEM	O	O	O	O	O	A	A
	RKE TIC	—	—	—	—	—	—	—	—	—	—	—	GEM	GEM	GEM	GEM	GEM	GEM	CAN GEM	CAN GEM
	Pad code	—	—	—	—	—	—	—	—	—	—	—	—	—	—	—	—	—	—	—
Ford GT	Procedure	—	—	—	—	—	—	—	—	—	—	—	—	—	—	A	A	—	—	—
	RKE TIC	—	—	—	—	—	—	—	—	—	—	—	—	—	—	—	—	—	—	—
	Pad code	—	—	—	—	—	—	—	—	—	—	—	—	—	—	—	—	—	—	—
Freestar	Procedure	—	—	—	—	—	—	—	—	—	—	—	—	—	A	A	A	A	—	—
	RKE TIC	—	—	—	—	—	—	—	—	—	—	—	—	—	GEM	GEM	GEM	GEM	—	—
	Pad code	—	—	—	—	—	—	—	—	—	—	—	—	—	GEM	GEM	GEM	GEM	—	—
Freestyle	Procedure	—	—	—	—	—	—	—	—	—	—	—	—	—	—	A	A	A	—	—
	RKE TIC	—	—	—	—	—	—	—	—	—	—	—	—	—	—	—	—	—	—	—
	Pad code	—	—	—	—	—	—	—	—	—	—	—	—	—	—	CAN GEM	CAN GEM	CAN GEM	—	—
Five Hundred	Procedure	—	—	—	—	—	—	—	—	—	—	—	—	—	—	A	A	A	—	—
	RKE TIC	—	—	—	—	—	—	—	—	—	—	—	—	—	—	—	—	—	—	—
	Pad code	—	—	—	—	—	—	—	—	—	—	—	—	—	—	CAN GEM	CAN GEM	CAN GEM	—	—
Fusion	Procedure	—	—	—	—	—	—	—	—	—	—	—	—	—	—	—	—	—	—	—
	RKE TIC	—	—	—	—	—	—	—	—	—	—	—	—	—	—	—	—	—	—	—
	Pad code	—	—	—	—	—	—	—	—	—	—	—	—	—	—	—	CAN GEM	—	CAN GEM	CAN GEM
Grand Marquis	Procedure	—	H	H	C	C	C	L - DDM	L - DDM	K, L - DDM	K, L - DDM	K, L - DDM	K, L - DDM	K, L - DDM	K, L - DDM	A, L - DDM	A	A	A	A
	RKE TIC	—	—	—	DDM	DDM	DDM	DDM	DDM	DDM	DDM	DDM	DDM	DDM	DDM	DDM	DDM	DDM	DDM	DDM
	Pad code	—	—	—	DDM	DDM	DDM	DDM	DDM	DDM	DDM	DDM	DDM	DDM	DDM	DDM	DDM	DDM	DDM	DDM
Lincoln LS	Procedure	—	—	—	—	—	—	—	—	L - DDM	L - DDM	L - DDM	A (L)	A (L)	A (L)	A (L)	—	—	—	—
	RKE TIC	—	—	—	—	—	—	—	—	—	—	—	—	—	—	DDM	DDM	—	—	—
	Pad code	—	—	—	—	—	—	—	—	—	DDM	DDM	DDM	DDM	DDM	DDM	DDM	—	—	—

CSM / VSM requires UBP cable (H105-00100)

CAN GEM requires Can VIM and MS CAN cable or CAN cable with adapter

\*\*\*Please refer to the vehicle's shop manual for RKE programming procedures

## RKE Transmitter Programming Method Look-up Chart

VEHICLE	Function	MODEL YEAR							MODEL YEAR											
		1992	1993	1994	1995	1996	1997	1998	1998.5	1999	2000	2001	2002	2003	2004	2005	2006	2007	2008	2009
Lincoln Mark VIII	Procedure	—	H	H	H	H	C	C	C	—	—	—	—	—	—	—	—	—	—	—
	RKE TIC	—	—	—	—	—	DDM	DDM	DDM	—	—	—	—	—	—	—	—	—	—	—
	Pad code	—	—	—	—	—	DDM	DDM	DDM	—	—	—	—	—	—	—	—	—	—	—
Mariner	Procedure	—	—	—	—	—	—	—	—	—	—	—	—	—	A	A	A	***	***	
	RKE TIC	—	—	—	—	—	—	—	—	—	—	—	—	—	—	—	—	—	—	
	Pad code	—	—	—	—	—	—	—	—	—	—	—	—	—	CAN GEM	CAN GEM	CAN GEM	CAN GEM	CAN GEM	
Milan	Procedure	—	—	—	—	—	—	—	—	—	—	—	—	—	—	PATS	—	—	—	
	RKE TIC	—	—	—	—	—	—	—	—	—	—	—	—	—	—	—	—	—	—	
	Pad code	—	—	—	—	—	—	—	—	—	—	—	—	—	—	CAN GEM	CAN GEM	CAN GEM	CAN GEM	
MKX	Procedure	—	—	—	—	—	—	—	—	—	—	—	—	—	—	—	—	***	***	***
	RKE TIC	—	—	—	—	—	—	—	—	—	—	—	—	—	—	—	—	—	—	
	Pad code	—	—	—	—	—	—	—	—	—	—	—	—	—	—	—	CAN GEM	CAN GEM	CAN GEM	
MKZ	Procedure	—	—	—	—	—	—	—	—	—	—	—	—	—	—	—	—	***	***	***
	RKE TIC	—	—	—	—	—	—	—	—	—	—	—	—	—	—	—	—	CAN GEM	CAN GEM	CAN GEM
	Pad code	—	—	—	—	—	—	—	—	—	—	—	—	—	—	—	—	—	—	
Montego	Procedure	—	—	—	—	—	—	—	—	—	—	—	—	—	A	A	A	—	—	
	RKE TIC	—	—	—	—	—	—	—	—	—	—	—	—	—	—	—	—	—	—	
	Pad code	—	—	—	—	—	—	—	—	—	—	—	—	—	CAN GEM	CAN GEM	CAN GEM	—	—	
Monterey	Procedure	—	—	—	—	—	—	—	—	—	—	—	—	A	A	A	A	—	—	
	RKE TIC	—	—	—	—	—	—	—	—	—	—	—	—	GEM	GEM	GEM	GEM	—	—	
	Pad code	—	—	—	—	—	—	—	—	—	—	—	—	GEM	GEM	GEM	GEM	—	—	
Mountaineer	Procedure	—	—	—	—	—	D	A	A	A	A	A	A**	A	A	A	A	A	A	
	RKE TIC	—	—	—	—	—	RAP	RAP	RAP	RAP	RAP	RAP	CSM	CSM	CSM	VSM	—	—	—	
	Pad code	—	—	—	—	—	RAP	RAP	RAP	RAP	RAP	RAP	CSM	CSM	CSM	VSM	CAN GEM	CAN GEM	CAN GEM	CAN GEM
Mustang	Procedure	—	—	B	B	B	B	B	B	A	A	A	A	A	A	A	A	A	A	
	RKE TIC	—	—	—	—	—	—	—	—	GEM	GEM	GEM	GEM	GEM	GEM	CAN GEM	CAN GEM	CAN GEM	CAN GEM	
	Pad code	—	—	—	—	—	—	—	—	—	—	—	—	—	—	—	—	CAN GEM	CAN GEM	CAN GEM
Mystique	Procedure	—	—	—	I	I	I	I	I	I	I	—	—	—	—	—	—	—	—	
	RKE TIC	—	—	—	—	—	—	—	—	—	—	—	—	—	—	—	—	—	—	
	Pad code	—	—	—	—	—	—	—	—	—	—	—	—	—	—	—	—	—	—	

CSM / VSM requires UBP cable (H105-00100)

CAN GEM requires Can VIM and MS CAN cable or CAN cable with adapter

\*\*\*Please refer to the vehicle's shop manual for RKE programming procedures

\*\*For 2002 MY (10 digit VIN = 2) with build date prior to March 2002:

1. Without Perimeter anti-theft (or disabled) open the driver's door and (with the door still open) press the interior power door UNLOCK switch.
2. Proceed to the procedure.

## RKE Transmitter Programming Method Look-up Chart

VEHICLE	Function	MODEL YEAR							MODEL YEAR												
		1992	1993	1994	1995	1996	1997	1998	1998.5	1999	2000	2001	2002	2003	2004	2005	2006	2007	2008	2009	
Navigator	Procedure	—	—	—	—	—	—	A	A	A	A	A	A	A	A	A	A	A	A	A	
	RKE TIC	—	—	—	—	—	—	RAP	RAP	RAP	RAP	RAP	RAP	RAP	CSM	CSM	—	—	CAN GEM	CAN GEM	CAN GEM
	Pad code	—	—	—	—	—	—	RAP	RAP	RAP	RAP	RAP	RAP	RAP	CSM	CSM	—	—	CAN GEM	CAN GEM	CAN GEM
Probe	Procedure		G	G	G	G	G	—	—	—	—	—	—	—	—	—	—	—	—	—	
	RKE TIC	—	—	—	—	—	—	—	—	—	—	—	—	—	—	—	—	—	—	—	
	Pad code	—	—	—	—	—	—	—	—	—	—	—	—	—	—	—	—	—	—	—	
Ranger	Procedure	—	—	—	D	D	D	A	A	A	A	A	A	A	A	A	A	A	A	A	
	RKE TIC	—	—	—	RAP	RAP	RAP	RAP	RAP	RAP	RAP	RAP	RAP	RAP	RAP	GEM	GEM	GEM	CN GEM	CAN GEM	CAN GEM
	Pad code	—	—	—	RAP	RAP	RAP	RAP	RAP	RAP	RAP	RAP	RAP	RAP	RAP	-	—	—	—	—	—
Sable	Procedure	—	B	B	B	D	D	A	A	A	A, L - GEM	A, L - GEM	A, L - GEM	A, L - GEM	A	A	A	—	***	***	
	RKE TIC	—	—	—	—	RAP	RAP	RAP	RAP	RAP	GEM	GEM	GEM	GEM	—	—	—	—	—	—	
	Pad code	—	—	—	—	RAP	RAP	RAP	RAP	RAP	GEM	GEM	GEM	GEM	CAN GEM	CAN GEM	CAN GEM	CAN GEM	CAN GEM	CAN GEM	
Taurus	Procedure	—	B	B	B	D	D	A	A	A	A, L - GEM	A, L - GEM	A, L - GEM	A, L - GEM	A	A	A	A	—	—	
	RKE TIC	—	—	—	—	RAP	RAP	RAP	RAP	RAP	GEM	GEM	GEM	GEM	—	—	—	—	—	—	
	Pad code	—	—	—	—	RAP	RAP	RAP	RAP	RAP	GEM	GEM	GEM	GEM	CAN GEM	CAN GEM	CAN GEM	CAN GEM	—	—	
Taurus X	Procedure	—	—	—	—	—	—	—	—	—	—	—	—	—	—	—	—	—	—	***	***
	RKE TIC	—	—	—	—	—	—	—	—	—	—	—	—	—	—	—	—	—	—	—	—
	Pad code	—	—	—	—	—	—	—	—	—	—	—	—	—	—	—	—	—	—	—	—
Thunderbird	Procedure	—	B	B	B	B	B	—	—	—	—	—	—	A, L - DDM	A, L - DDM	A, L - DDM	A, L - DDM	—	—	—	
	RKE TIC	—	—	—	—	—	—	—	—	—	—	—	—	DDM	DDM	DDM	DDM	—	—	—	—
	Pad code	—	—	—	—	—	—	—	—	—	—	—	—	DDM	DDM	DDM	DDM	—	—	—	—
Town Car	Procedure	—	H	H	C	C	C	K	K, L - DDM	K, L - DDM	K, L - DDM	K, L - DDM	K, L - DDM	K, L - DDM	A, L - DDM	A, L - DDM	A	A	A	A	
	RKE TIC	—	—	—	DDM	DDM	DDM	DDM	DDM	DDM	DDM	DDM	DDM	DDM	DDM	DDM	DDM	DDM	DDM	DDM	DDM
	Pad code	—	—	—	DDM	DDM	DDM	DDM	DDM	DDM	DDM	DDM	DDM	DDM	DDM	DDM	DDM	DDM	DDM	DDM	DDM
Villager	Procedure	—	—	—	—	E	E	E	E	N	N	N	N	—	—	—	—	—	—	—	
	RKE TIC	—	—	—	—	—	—	—	—	—	—	—	—	—	—	—	—	—	—	—	—
	Pad code	—	—	—	—	—	—	—	—	—	—	—	—	—	—	—	—	—	—	—	—
Windstar	Procedure	—	—	—	H	H	H	D	A	A	A	A	A, L - DDM	A	—	—	—	—	—	—	
	RKE TIC	—	—	—	—	—	RAP	RAP	RAP	DDM	DDM	DDM	DDM	DDM	—	—	—	—	—	—	—
	Pad code	—	—	—	—	—	RAP	RAP	RAP	DDM*	DDM*	DDM*	DDM	DDM	—	—	—	—	—	—	—
Zephyr	Procedure	—	—	—	—	—	—	—	—	—	—	—	—	—	—	—	—	***	—	—	—
	RKE TIC	—	—	—	—	—	—	—	—	—	—	—	—	—	—	—	—	—	—	—	—
	Pad code	—	—	—	—	—	—	—	—	—	—	—	—	—	—	—	—	CAN GEM	—	—	—

CSM / VSM requires UBP cable (H105-00100) CAN GEM requires Can VIM and MS CAN cable or CAN cable with adapter

\*\*\*Please refer to the vehicle's shop manual for RKE programming procedures \* Use card ver 21.2 or higher